

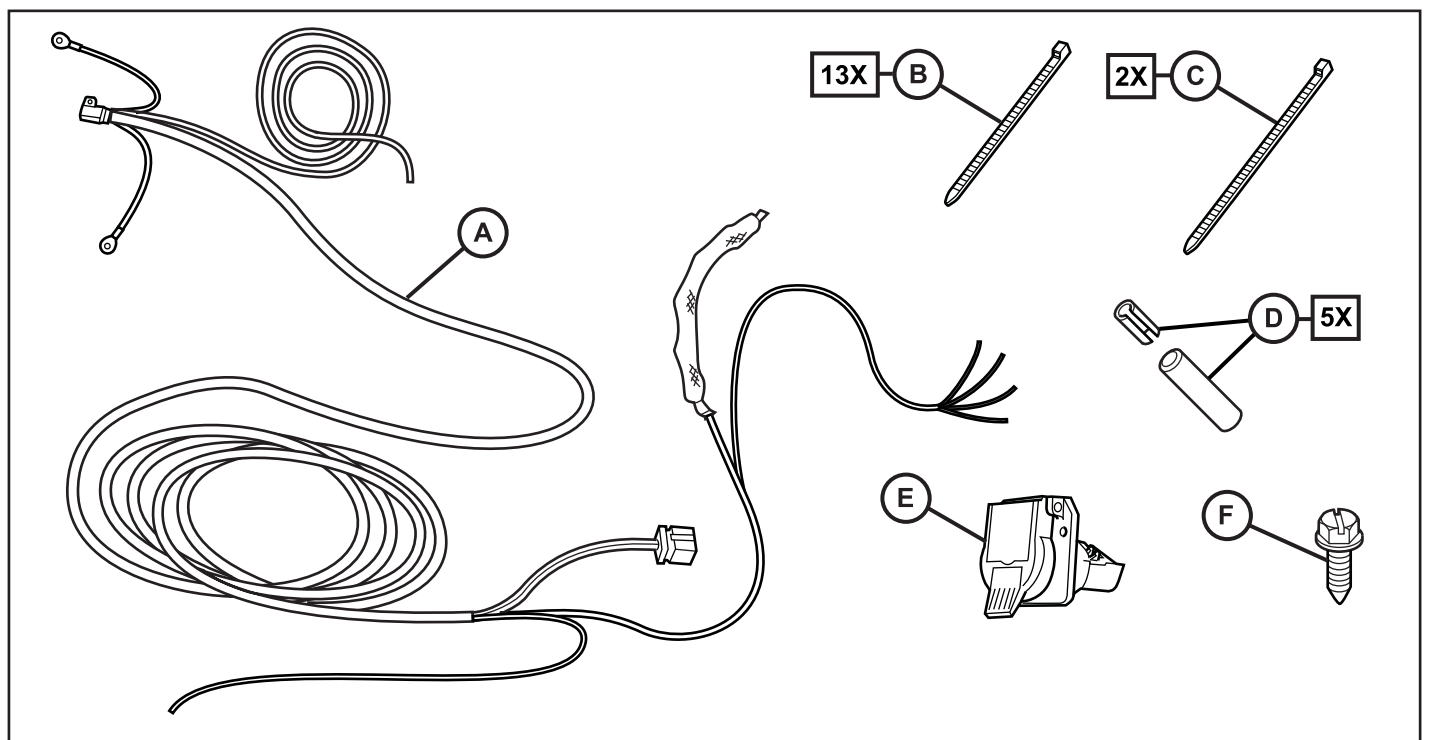

DODGE SPRINTER

7-Way Trailer Tow Harness



T-20 T-25 T-30 T-40 10 mm 13 mm								
1/2" (12mm)						82300508	RTV SEALANT	

STANDARD VAN

V170 EXTENDED VAN

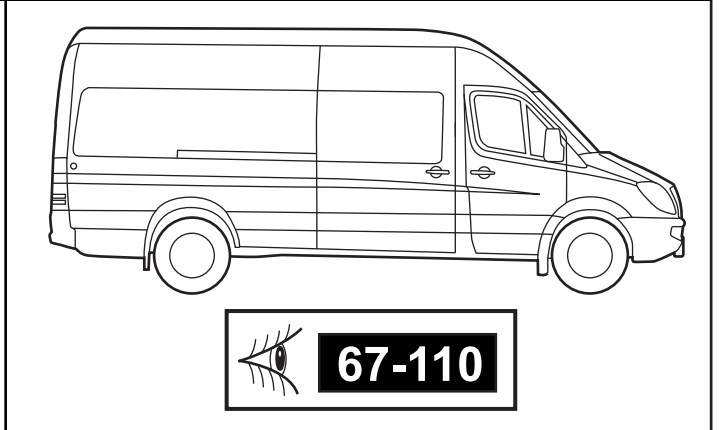
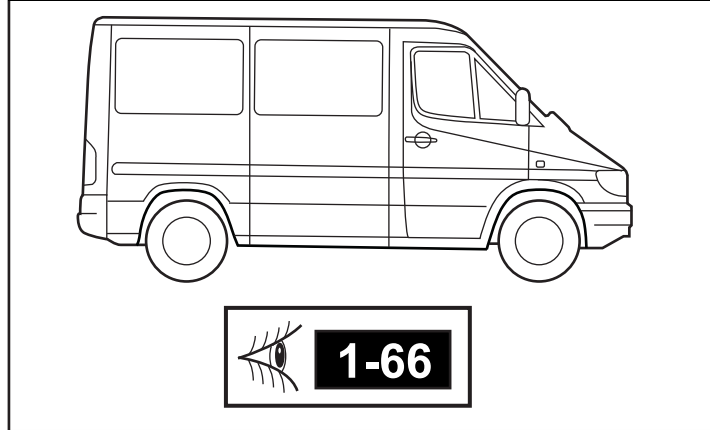

STANDARD VAN

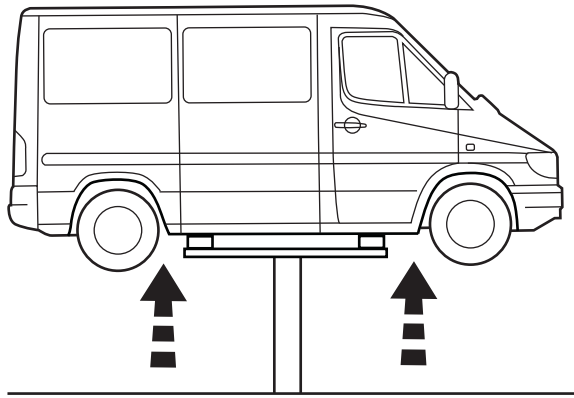

1

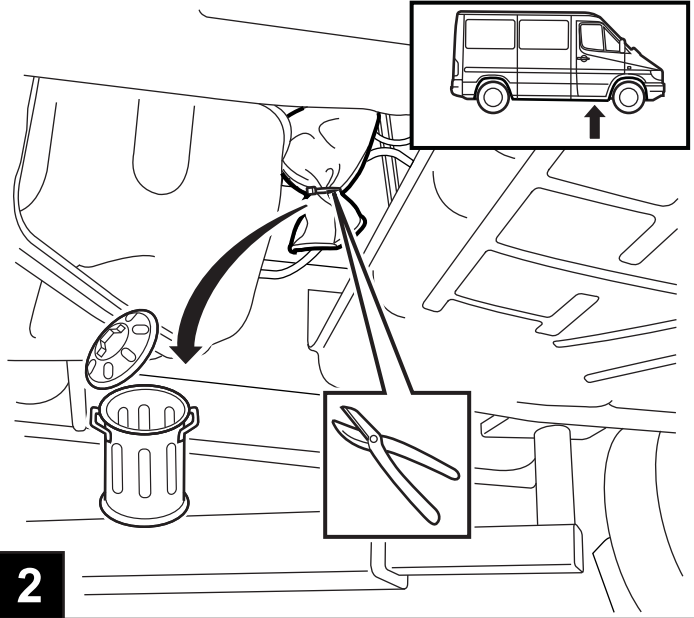

2

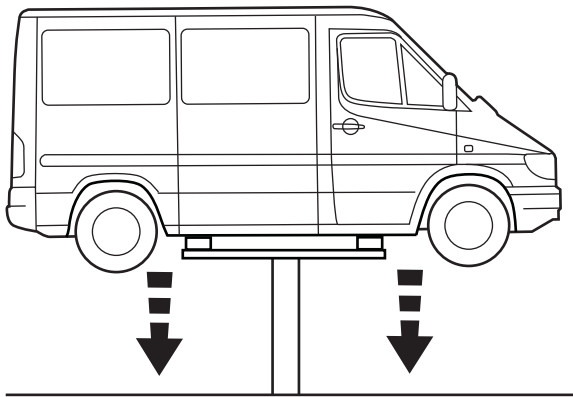

3

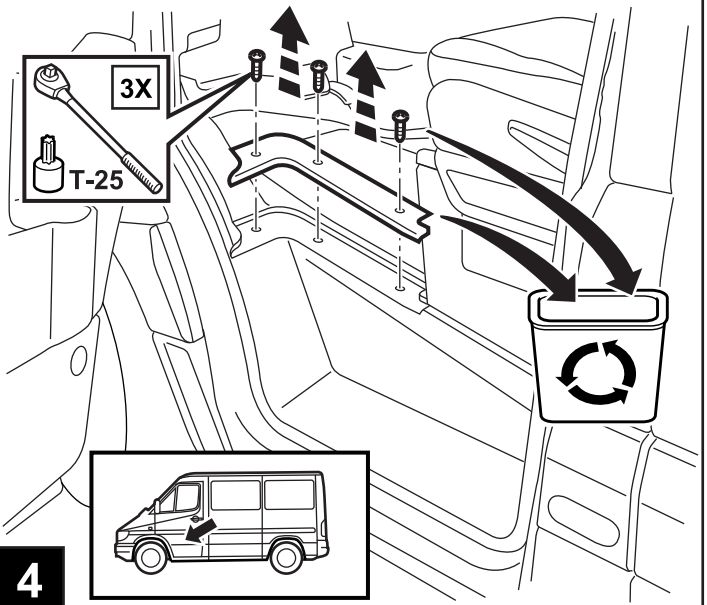

4

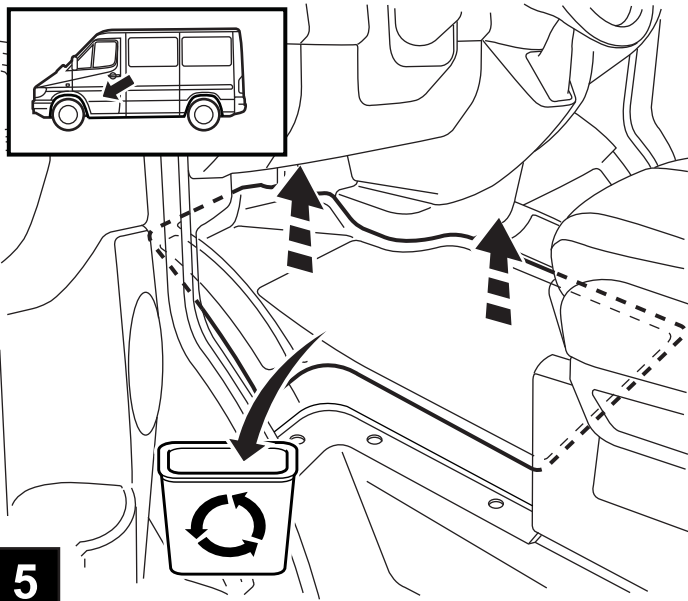

5

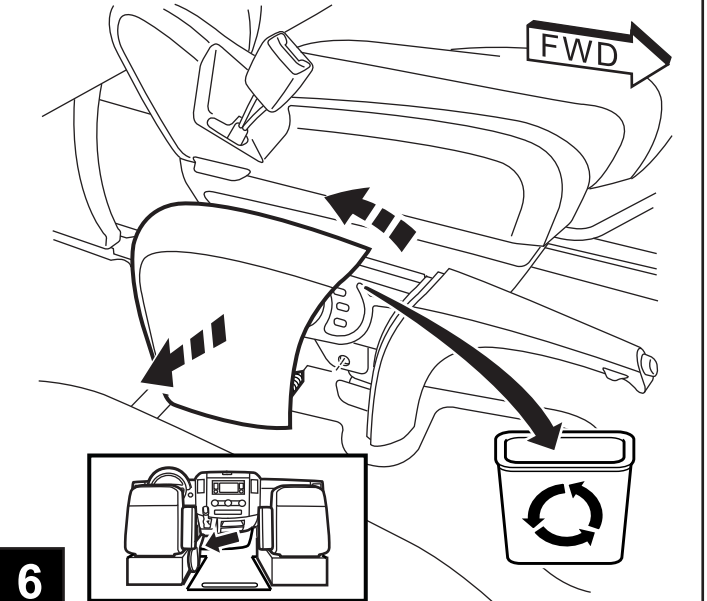

6

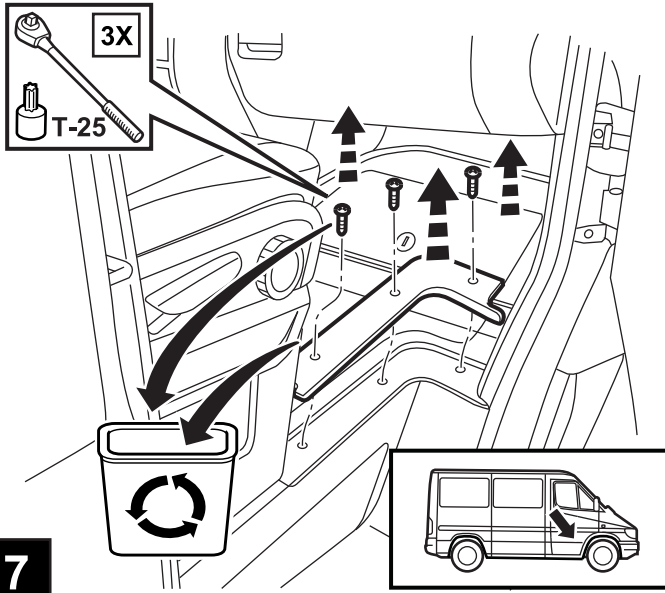

7

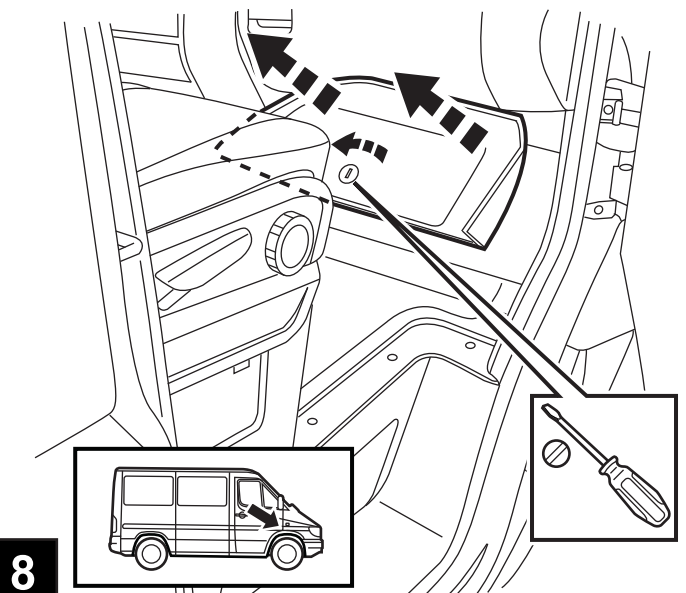

8

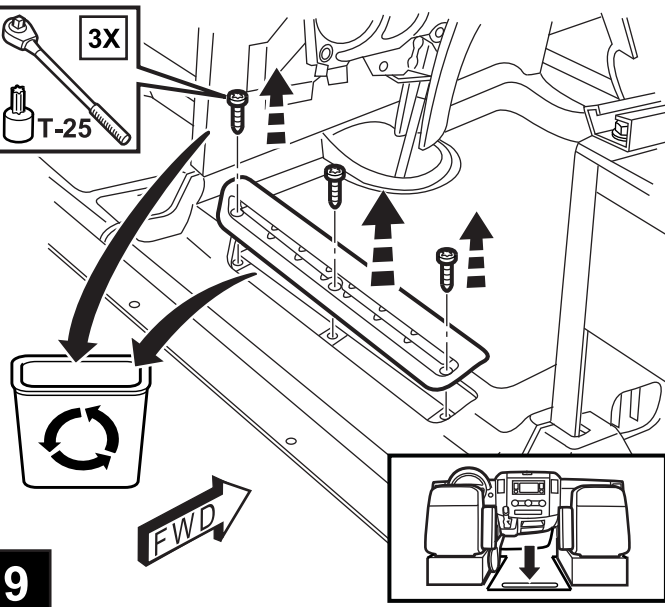

9

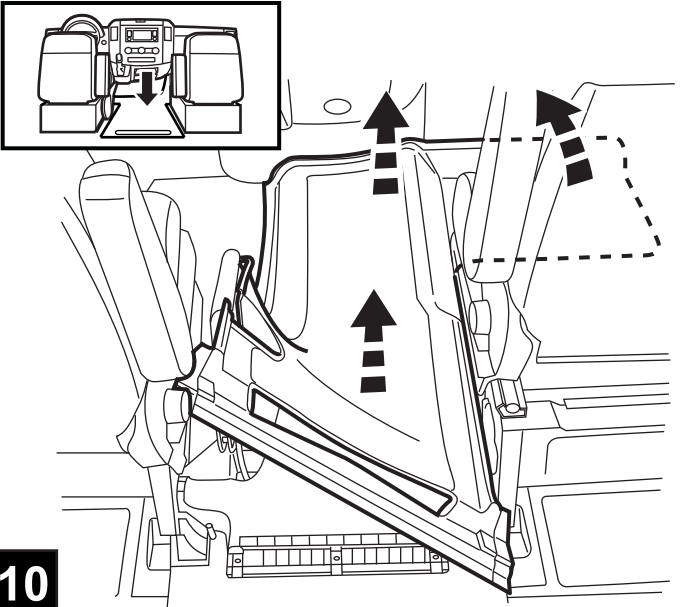

10

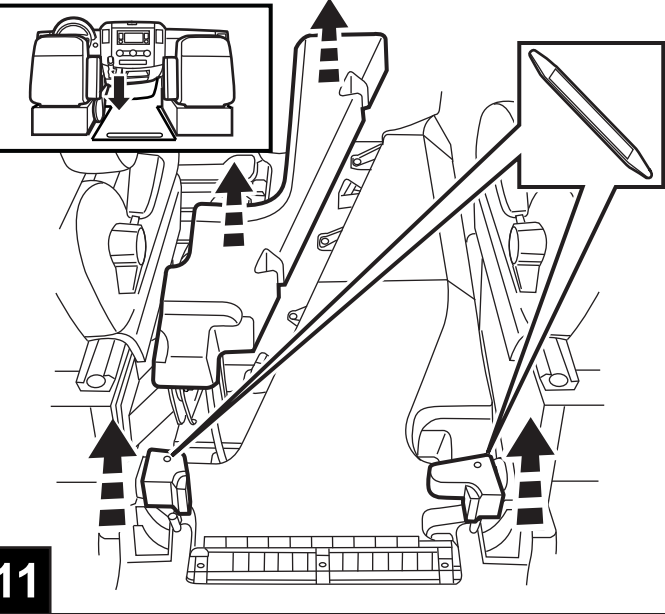

11

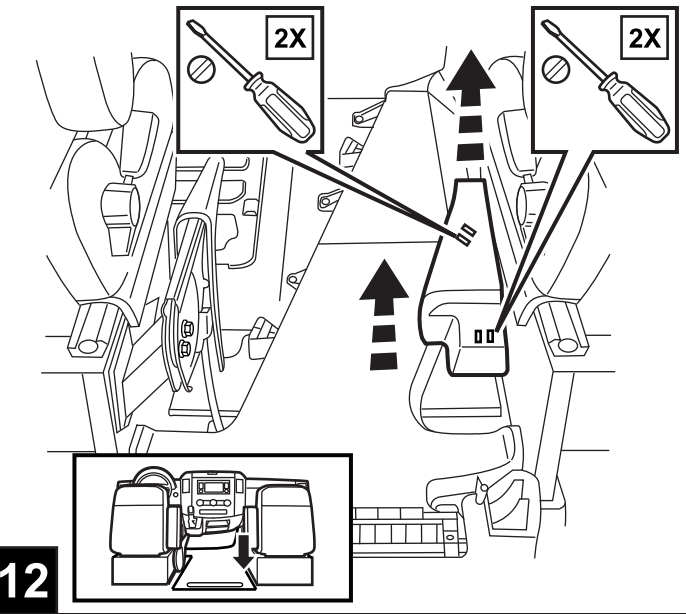

12

STANDARD VAN

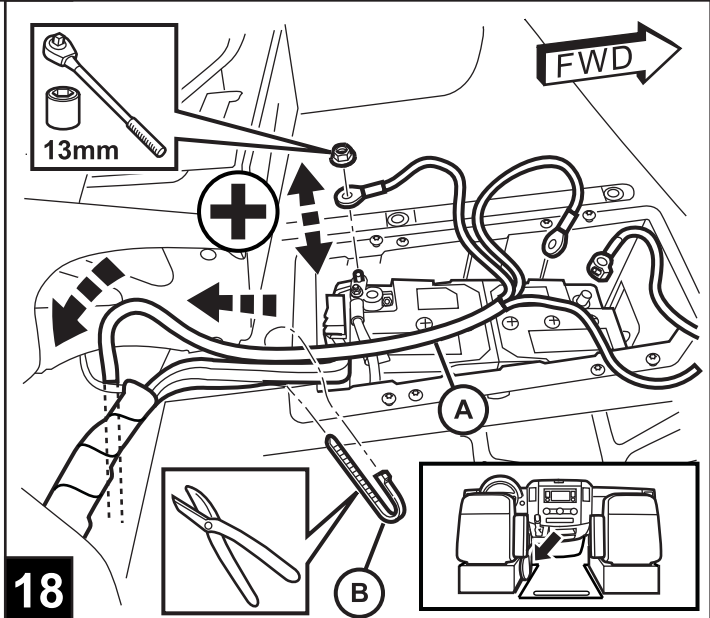
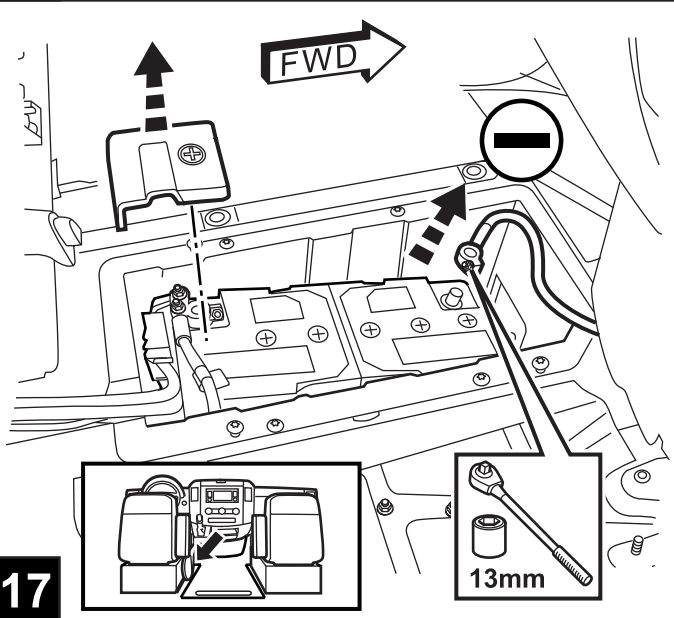
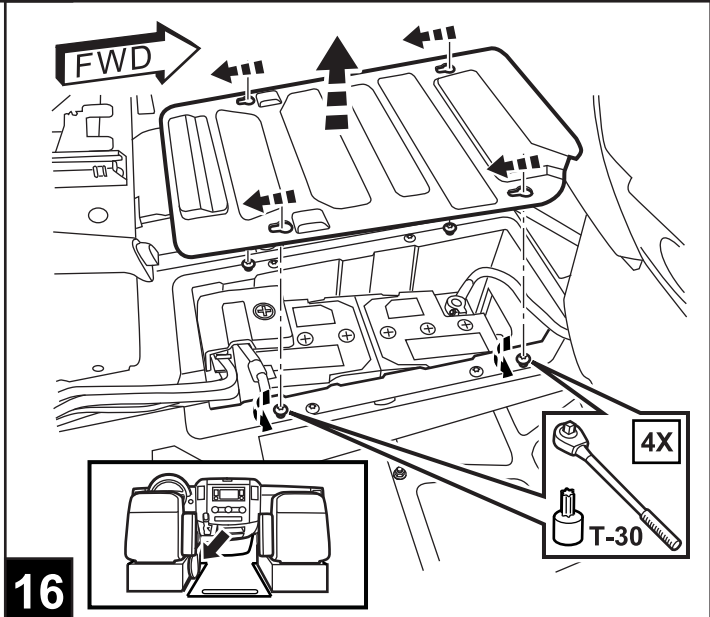
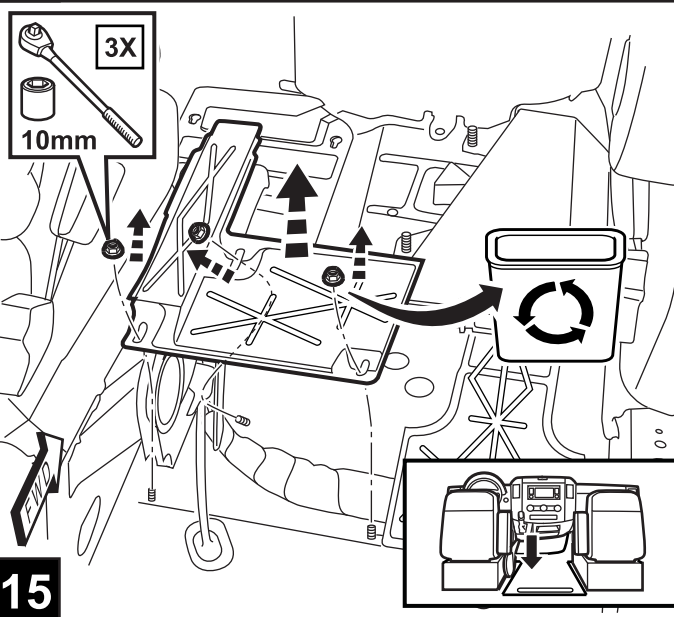
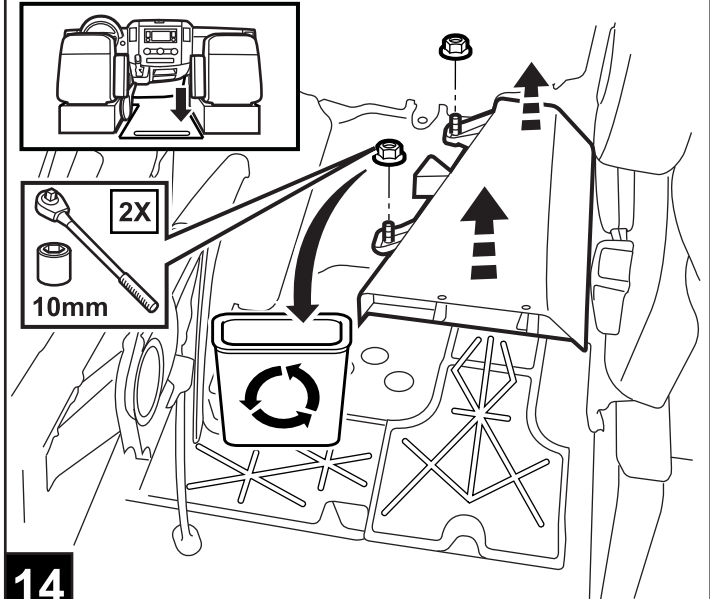
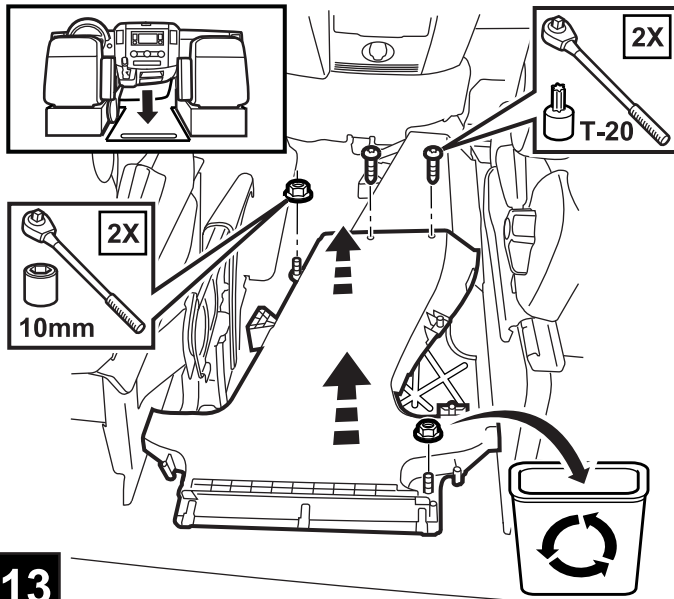

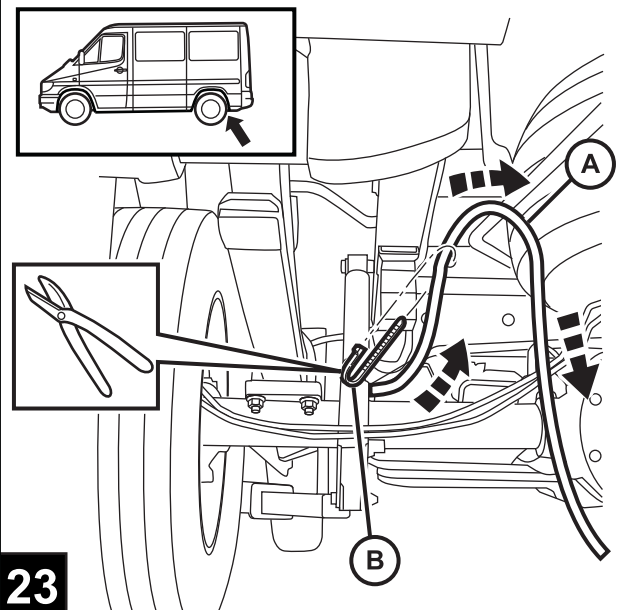
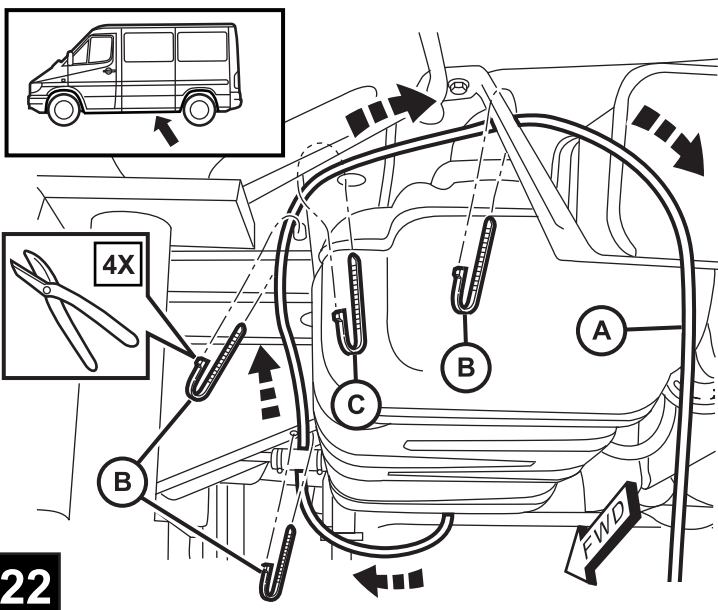
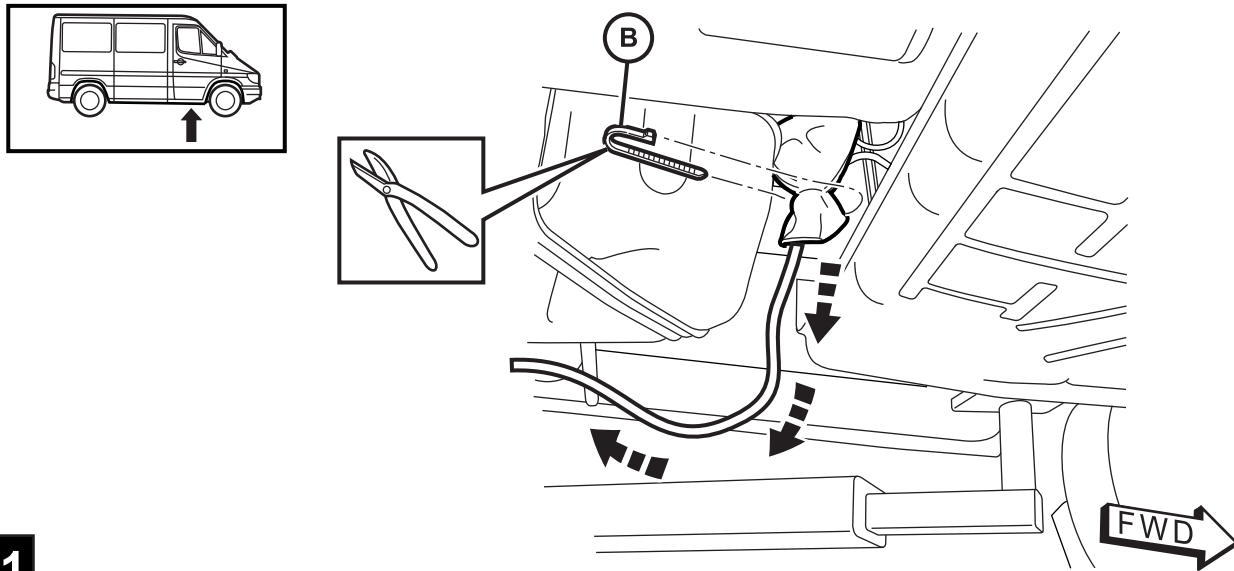
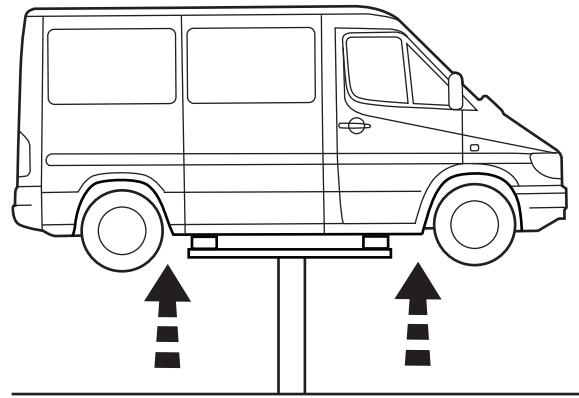
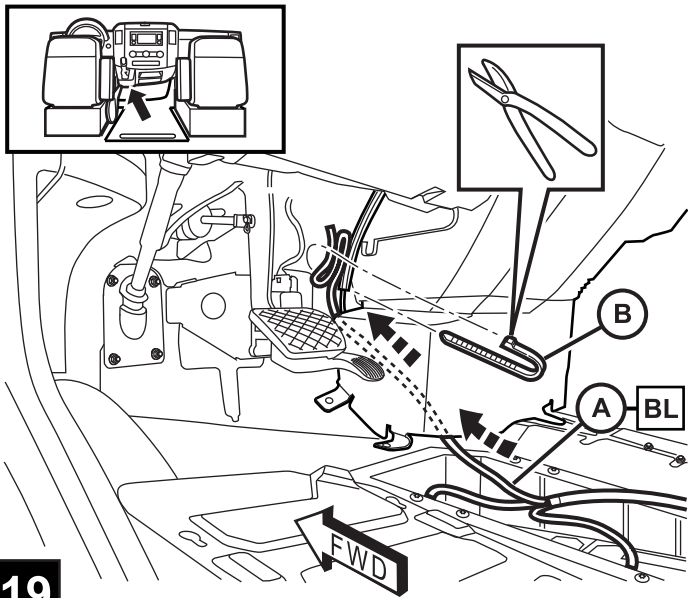

STANDARD VAN

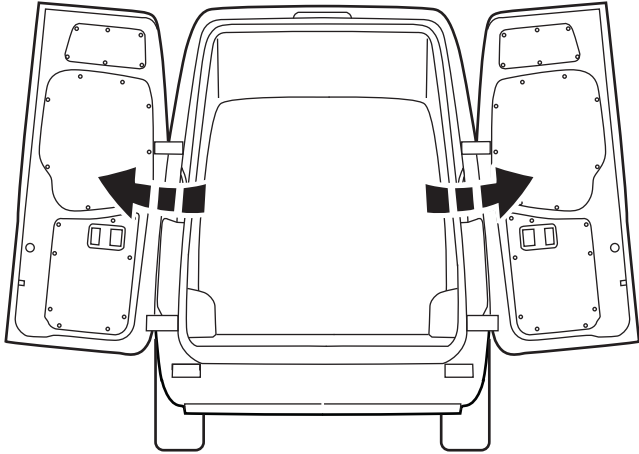

24

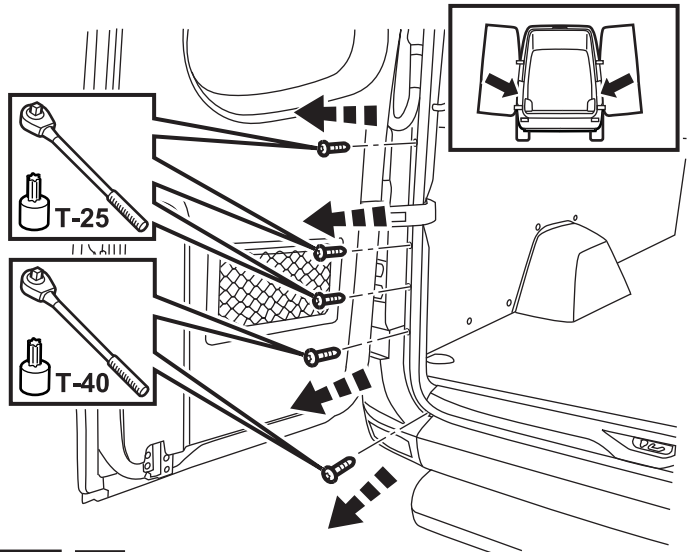

25 2X

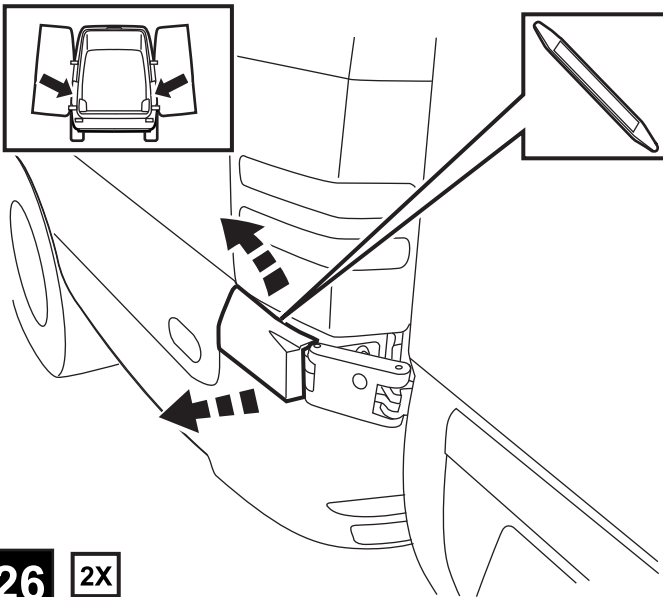

26 2X

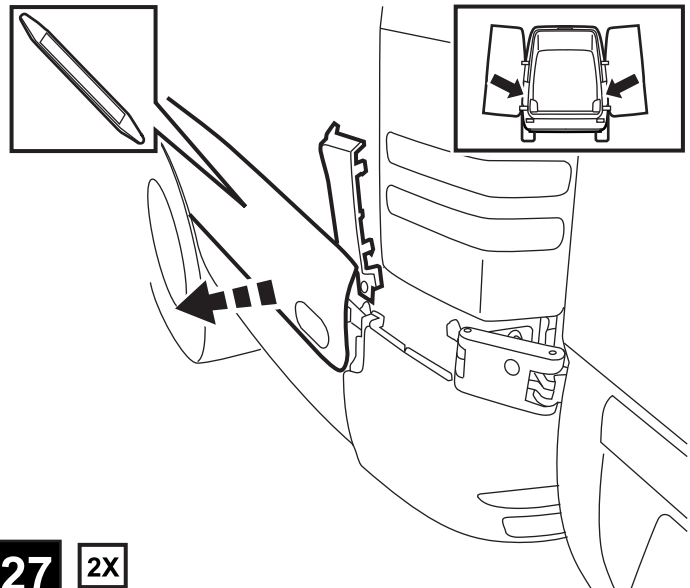

27 2X

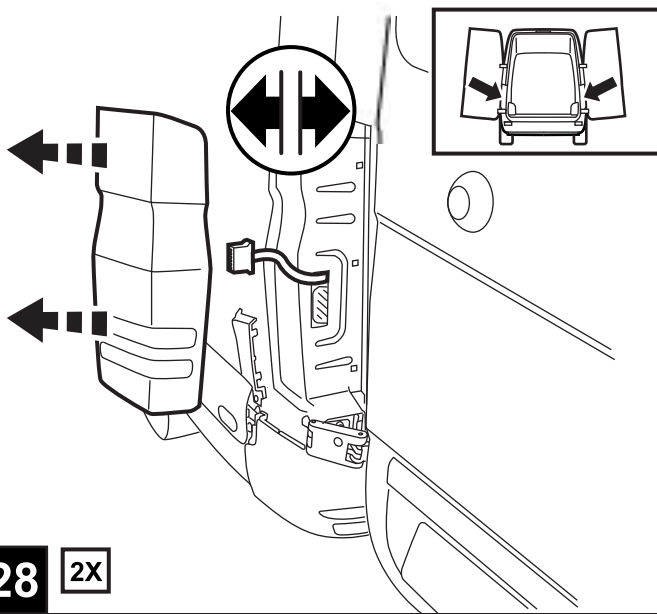

28 2X

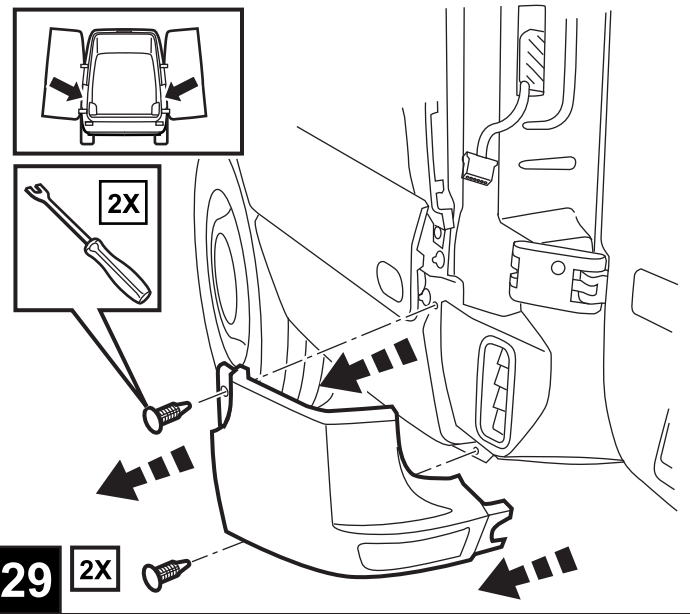

29 2X

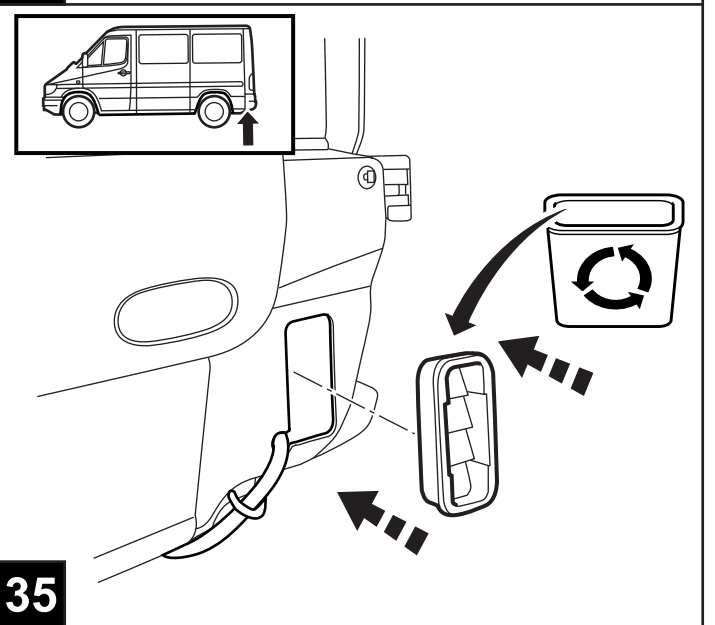
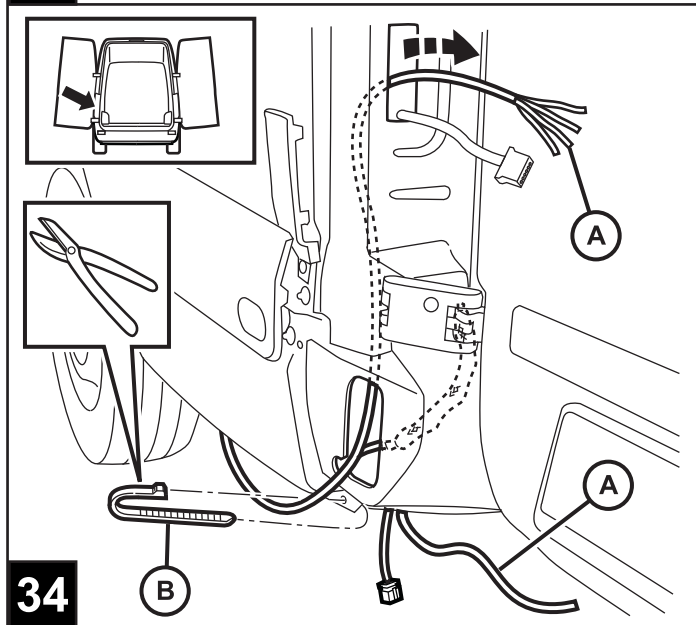
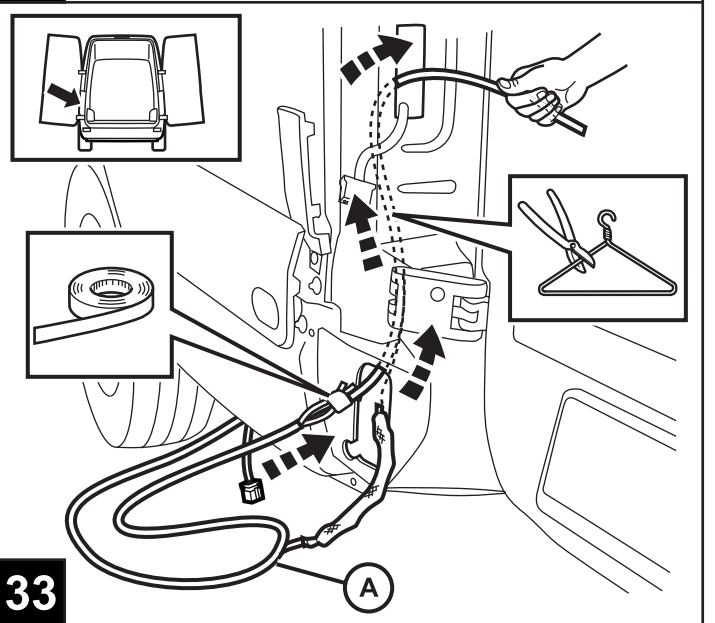
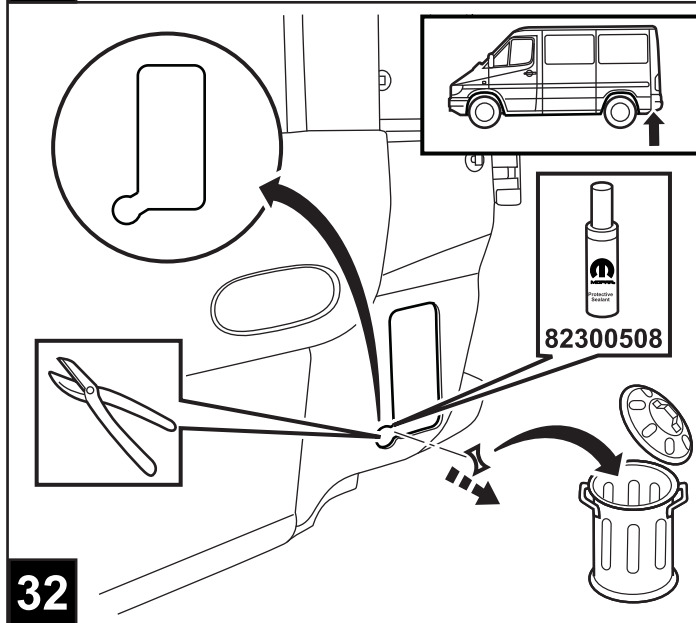
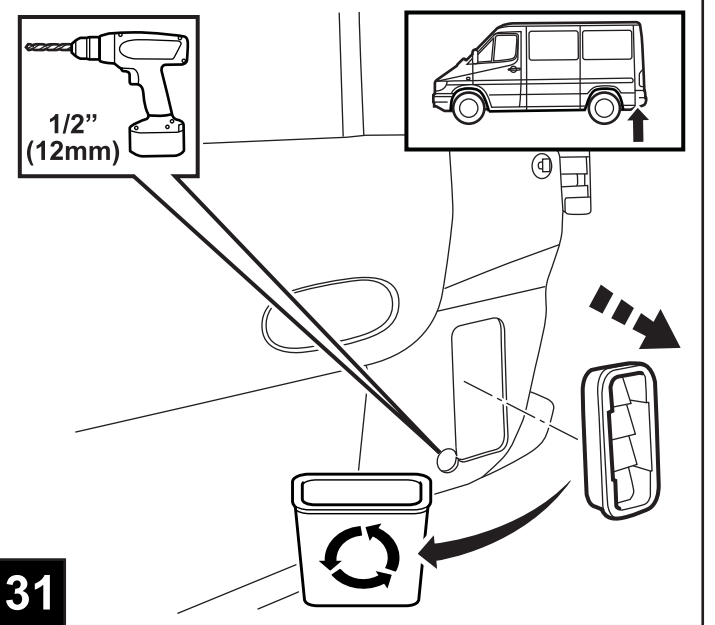
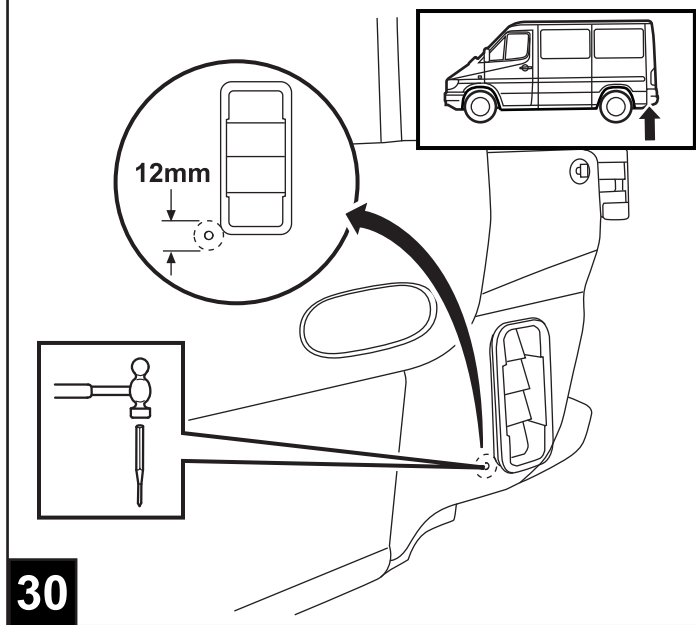

STANDARD VAN

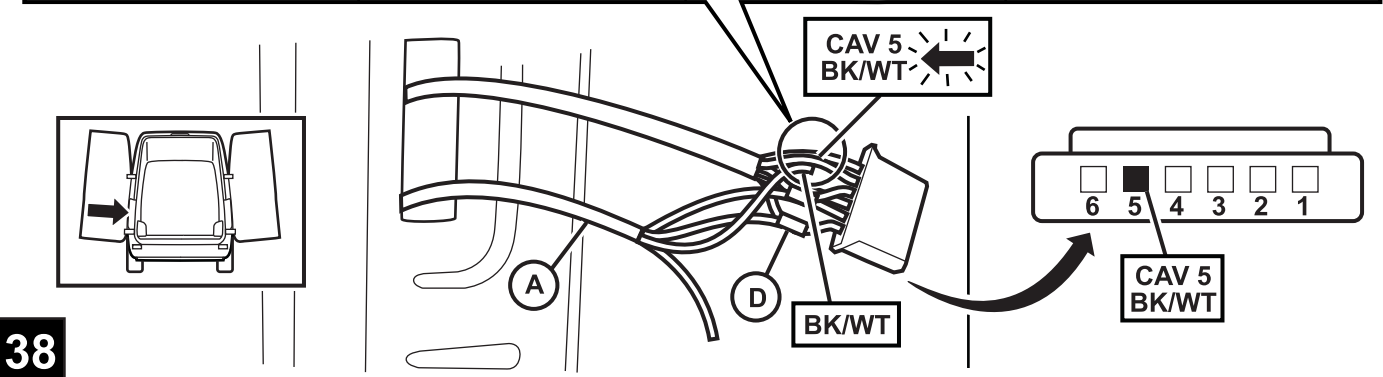
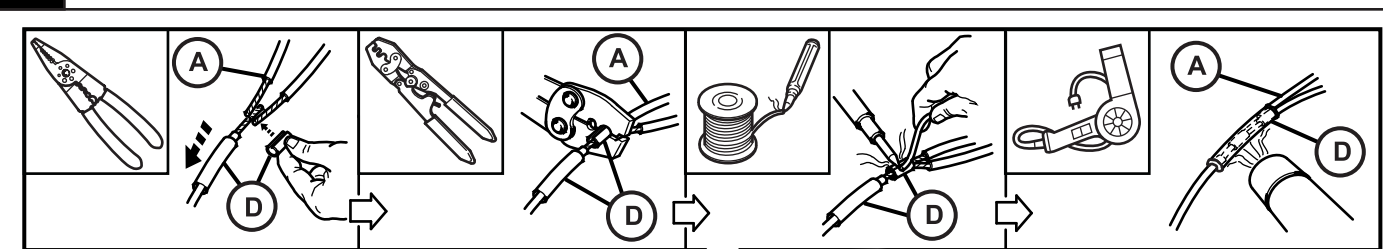
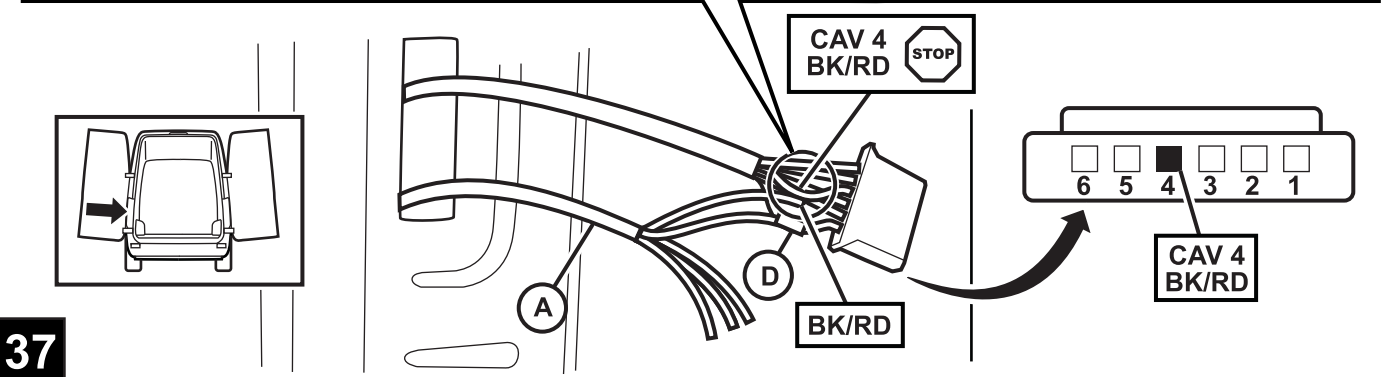
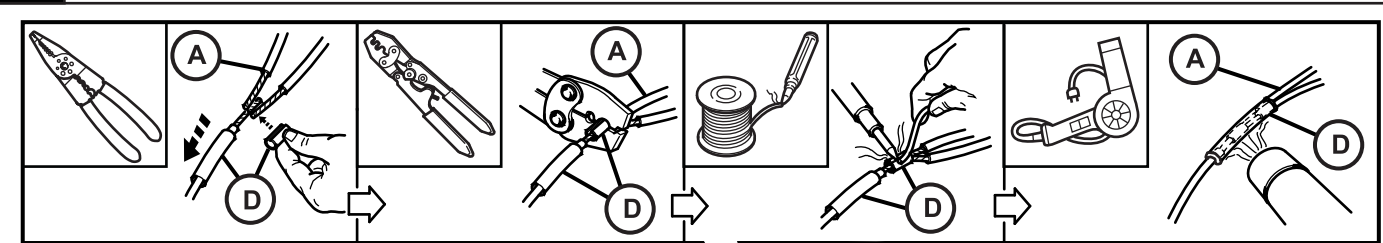
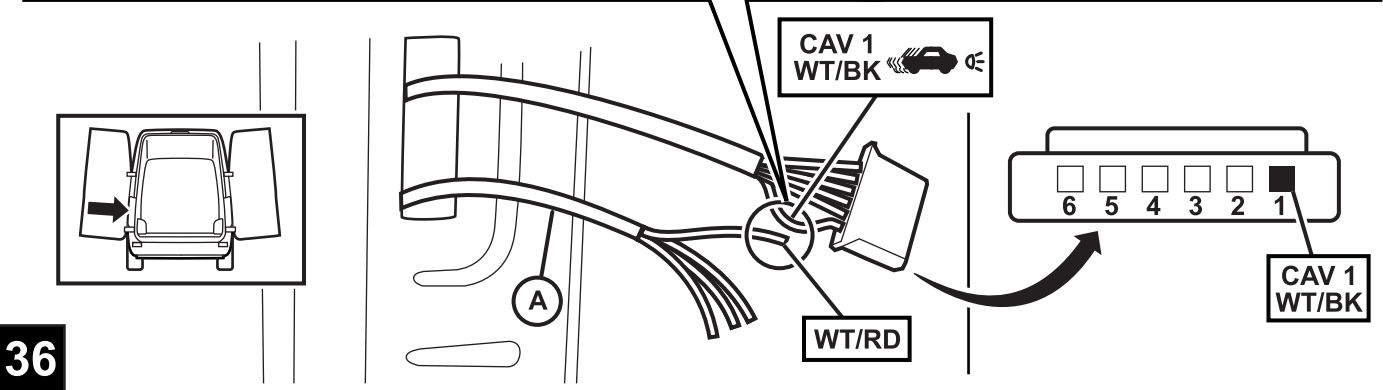
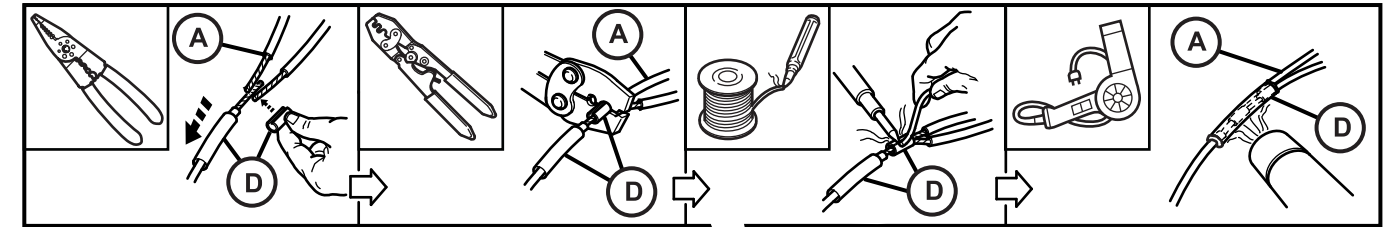

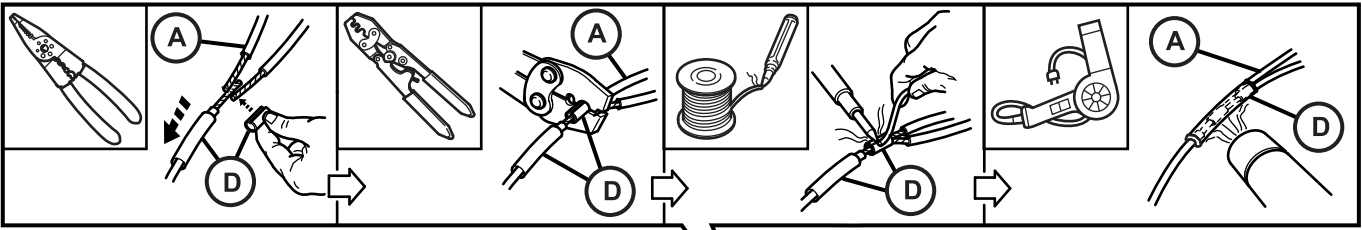

39

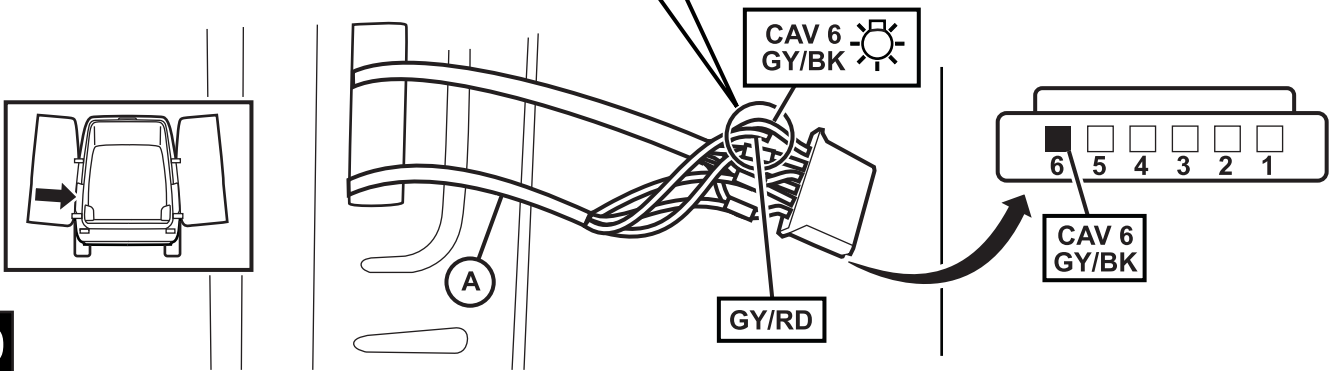

40

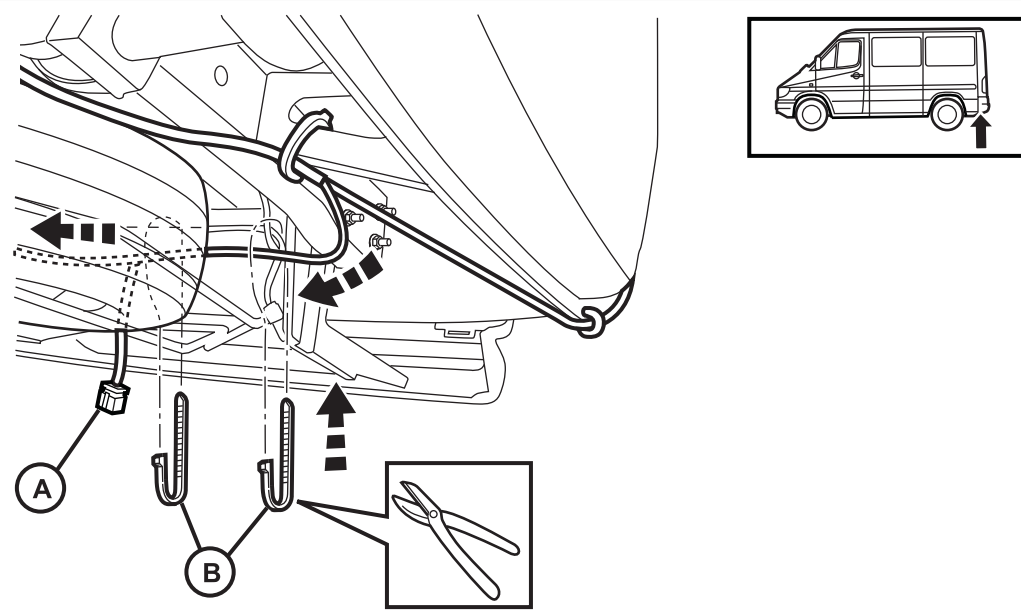

41

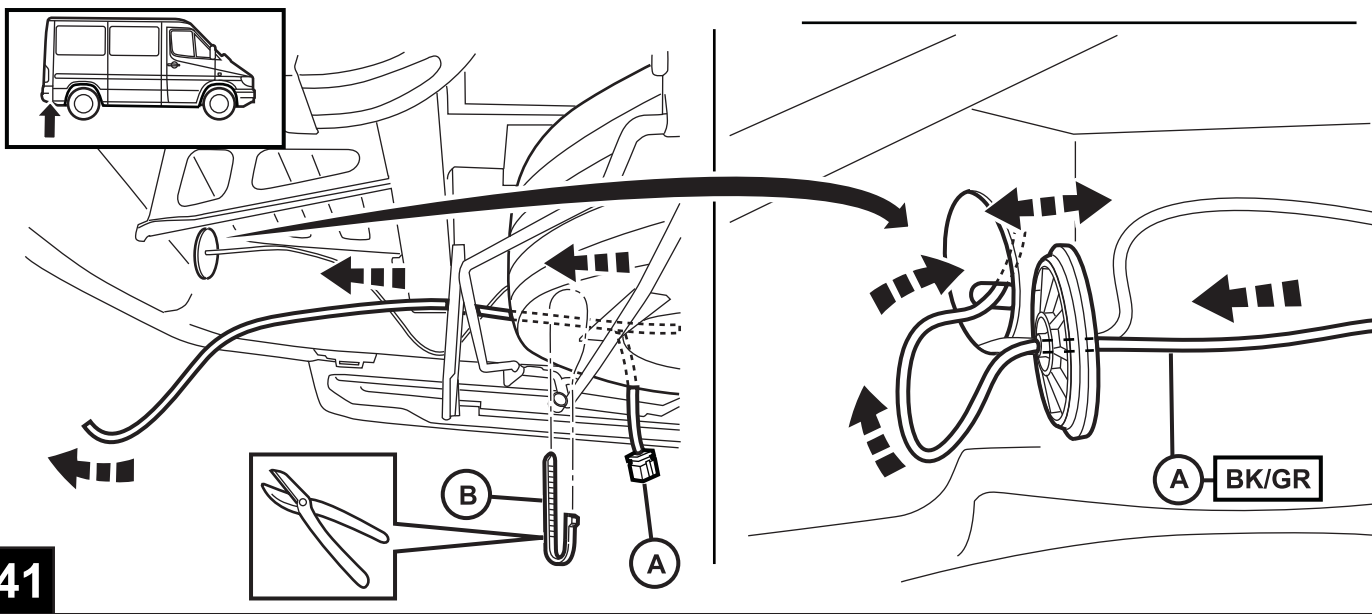

STANDARD VAN

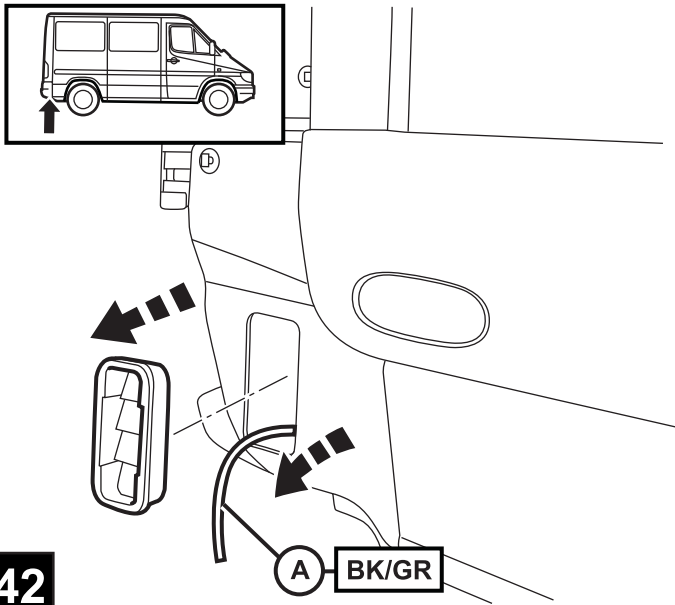

42

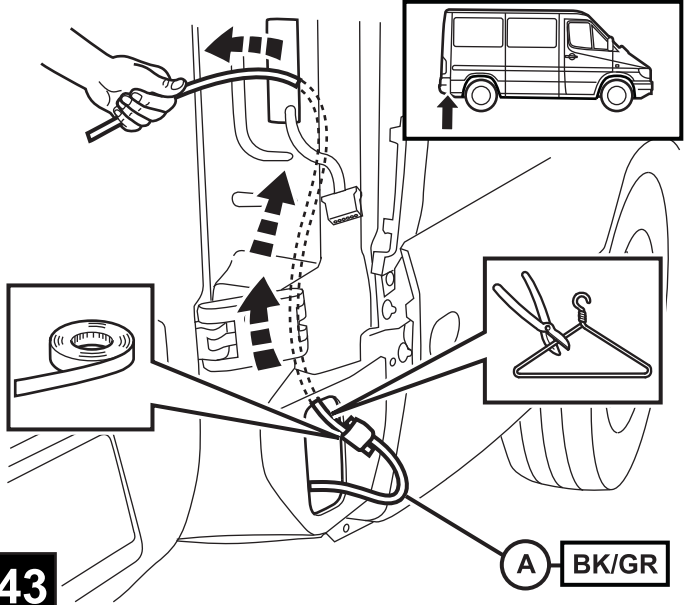

43

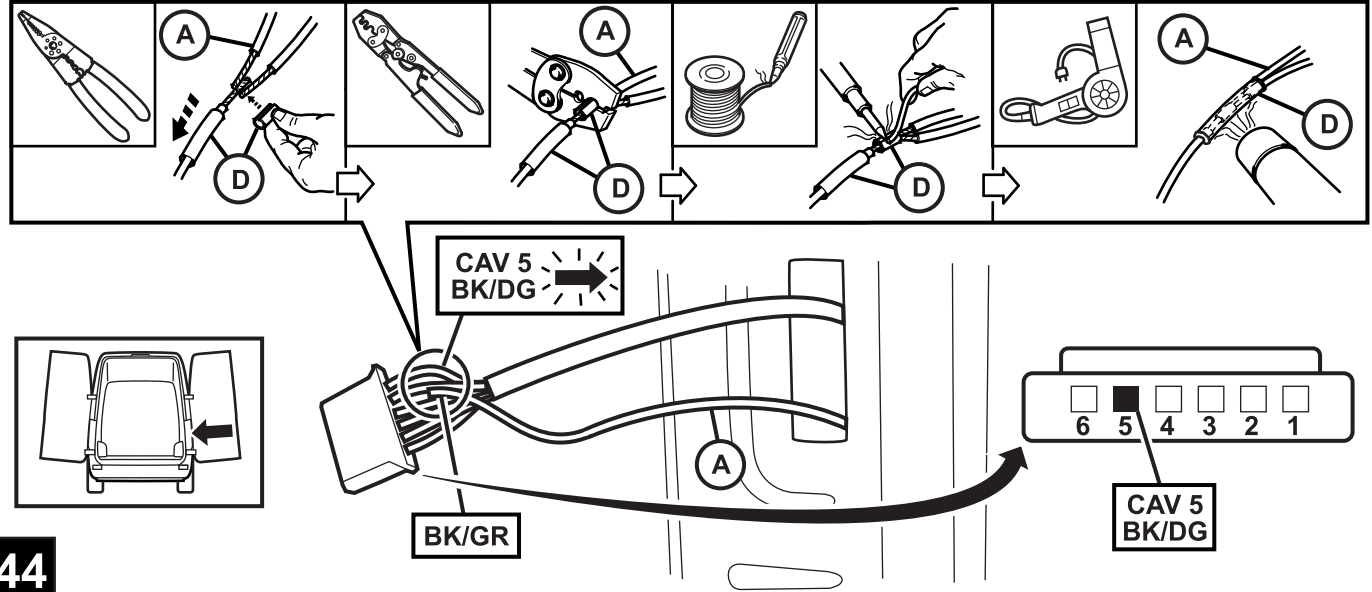

44

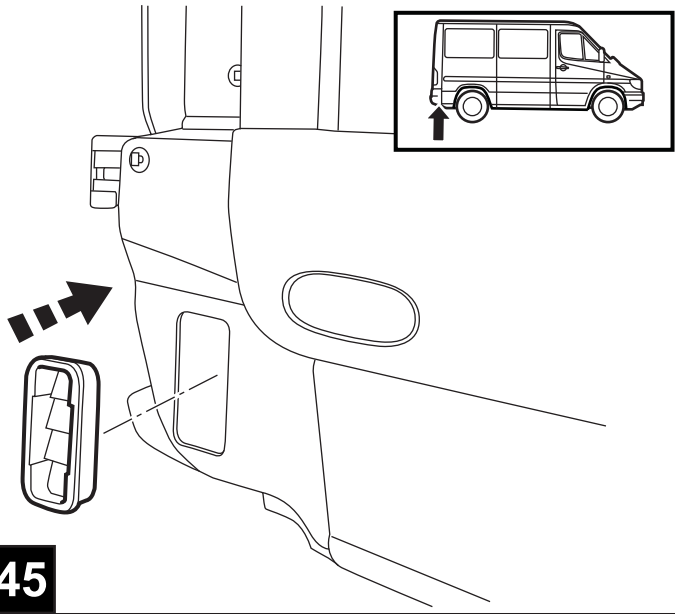

45

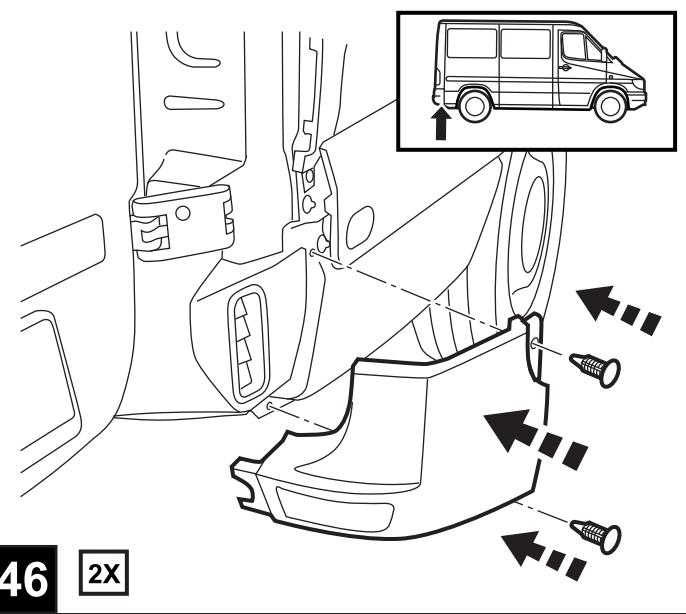

46

2X

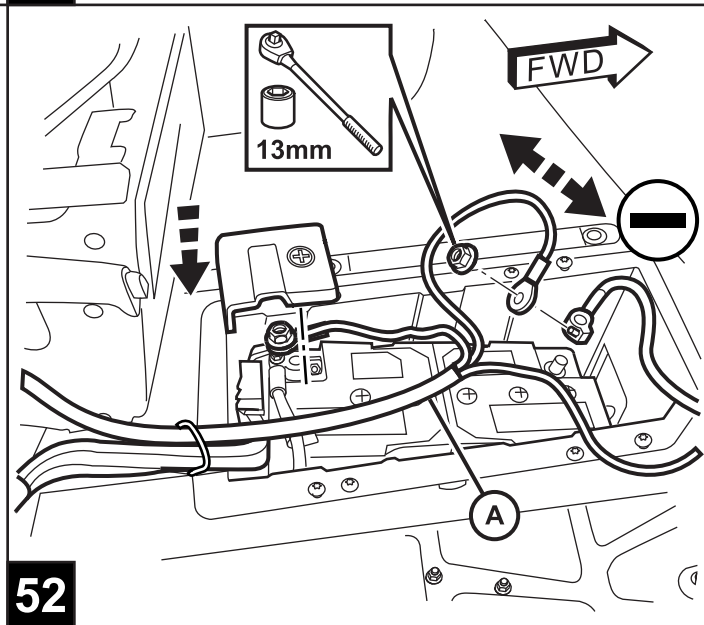
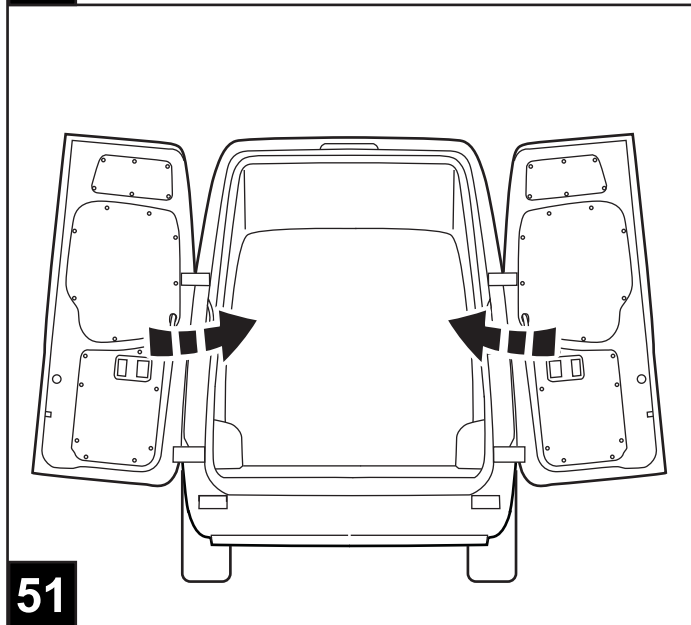
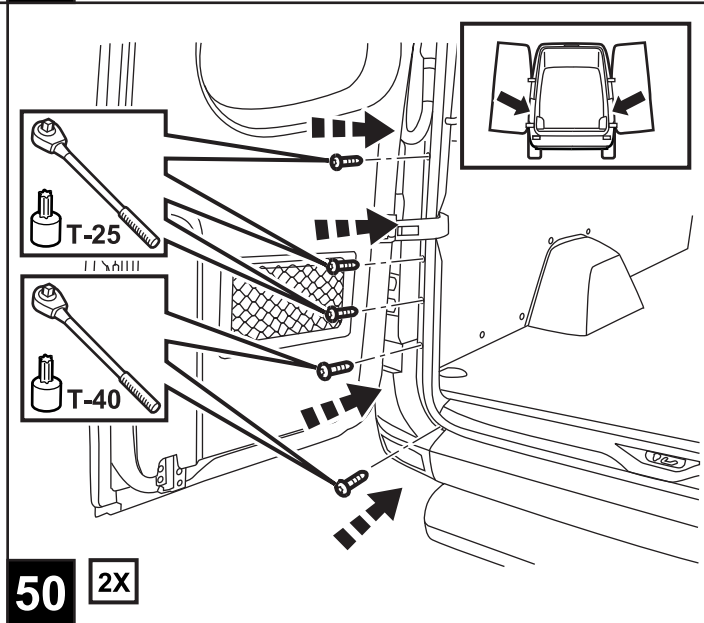
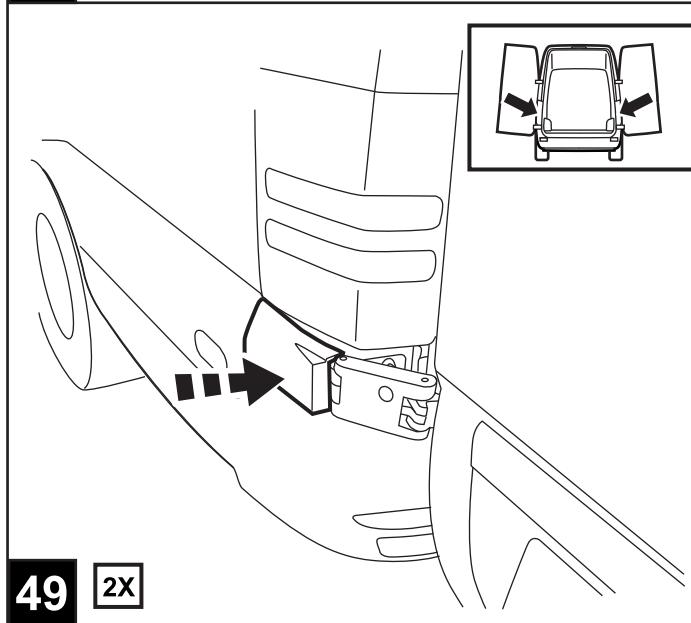
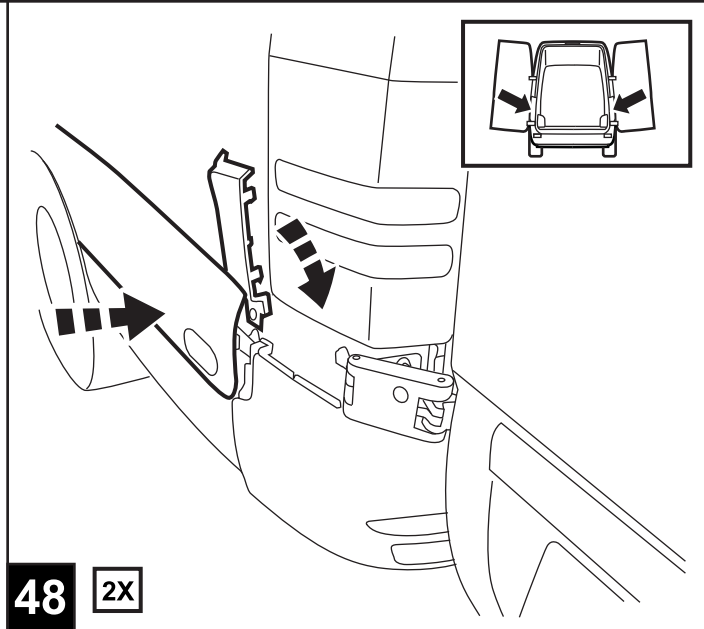
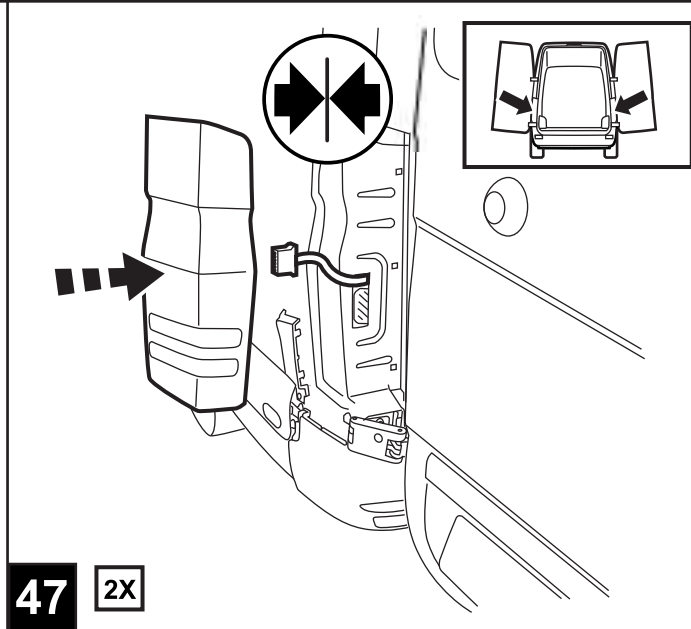

STANDARD VAN

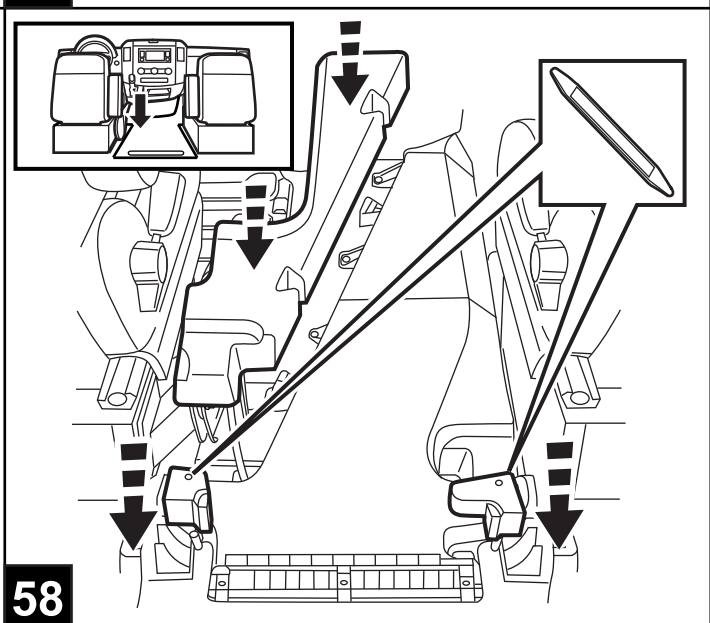
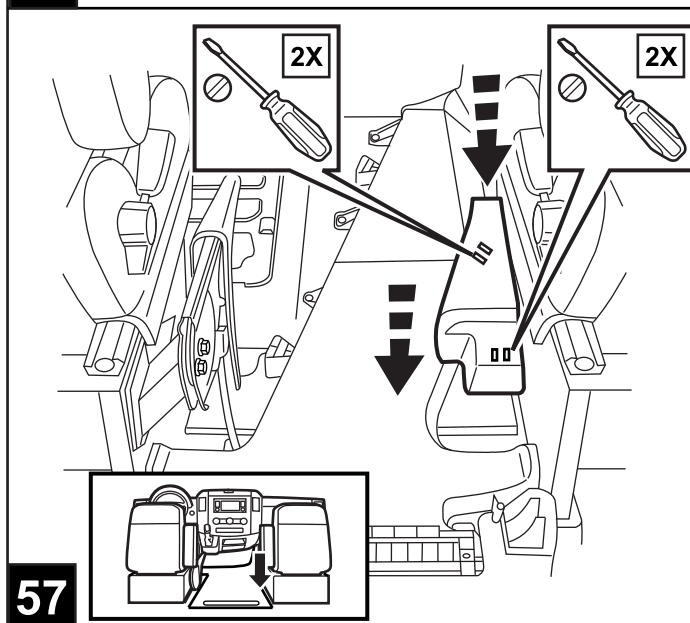
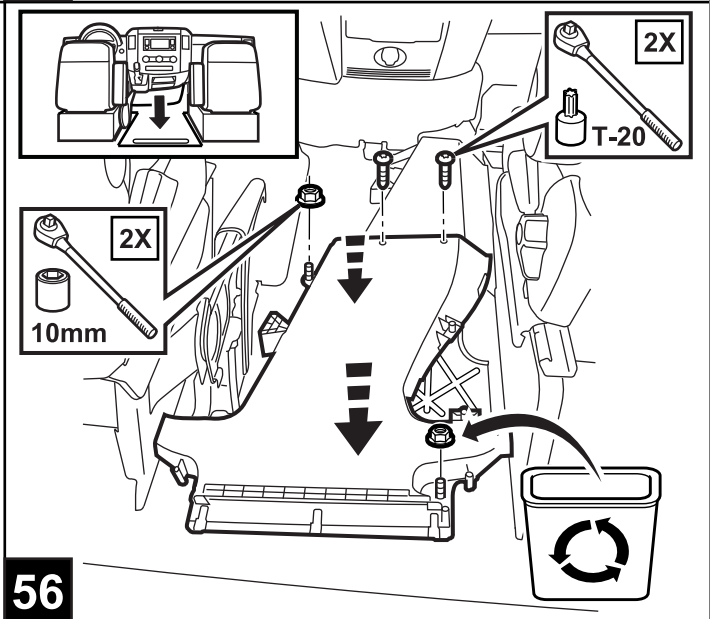
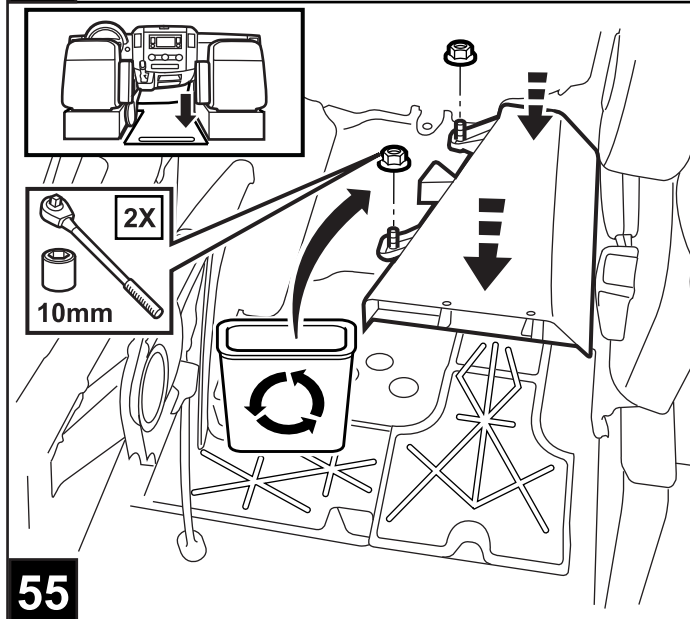
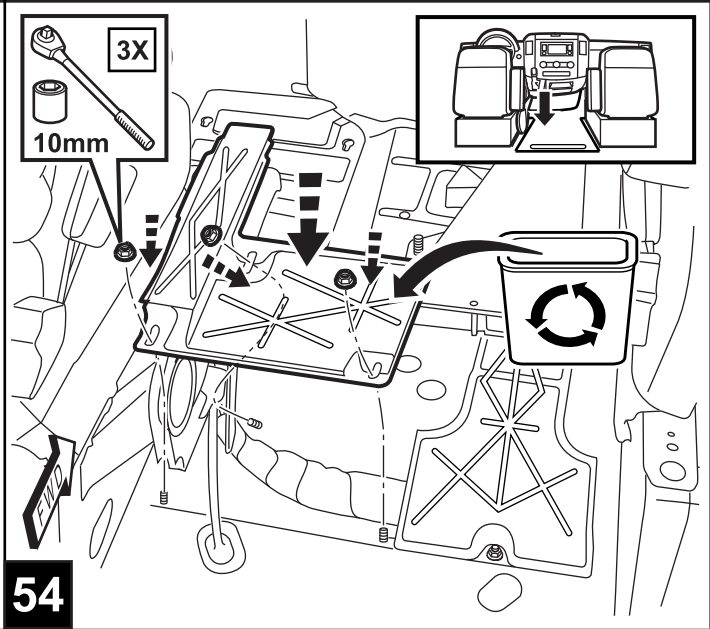
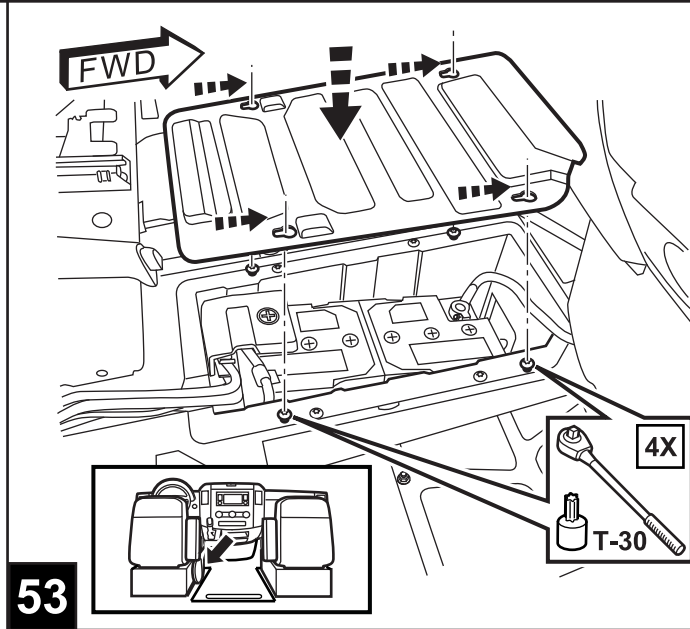

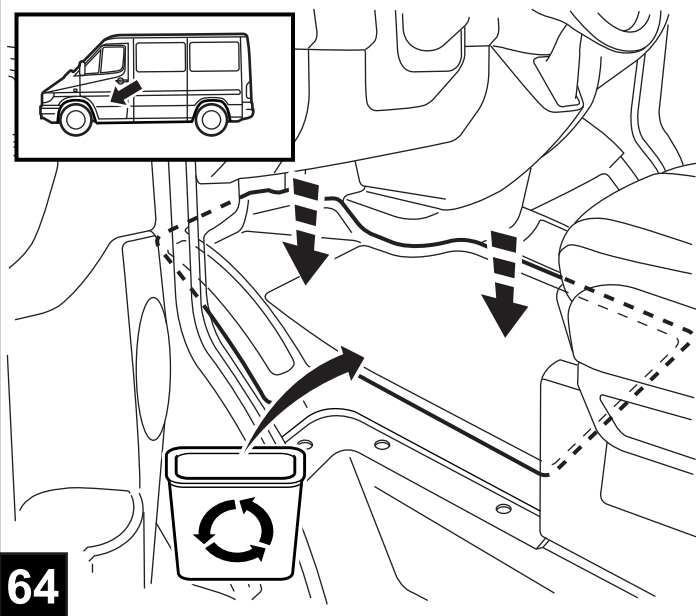
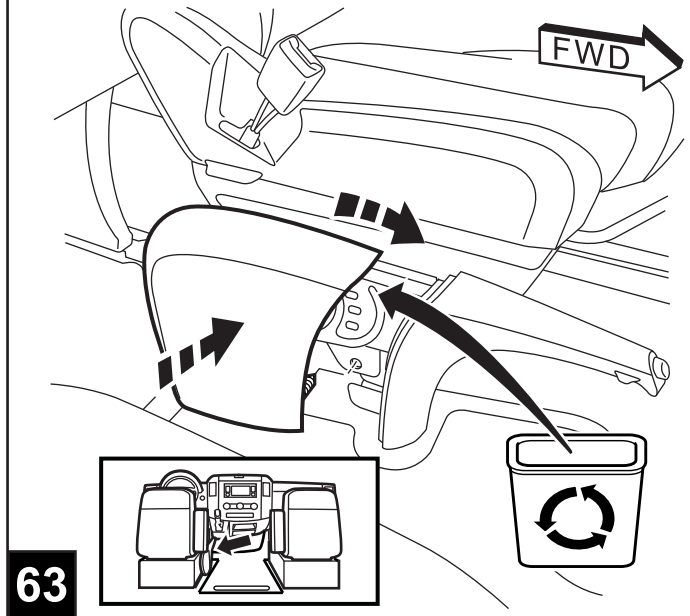
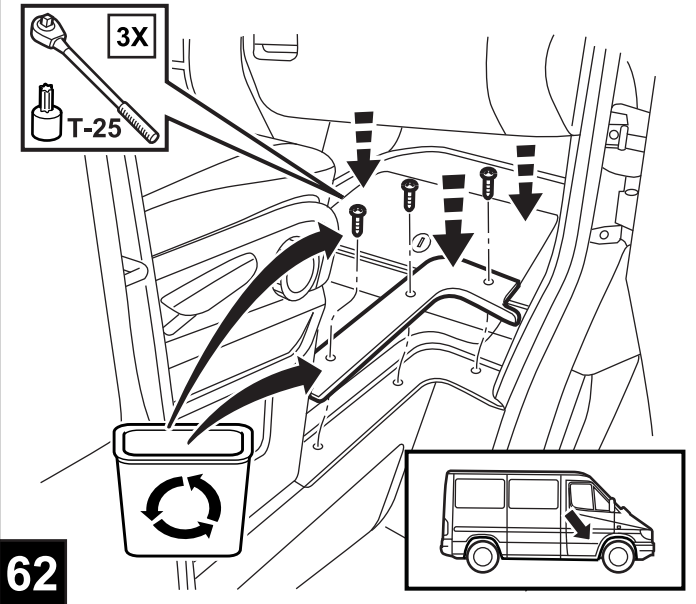
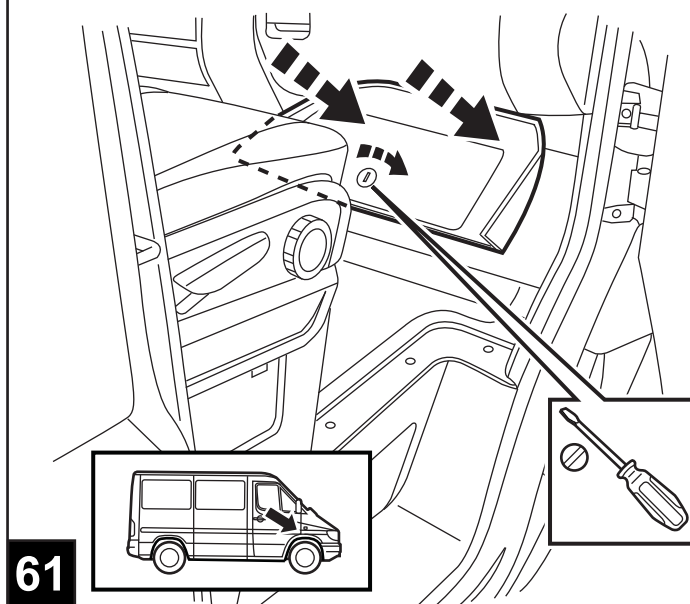
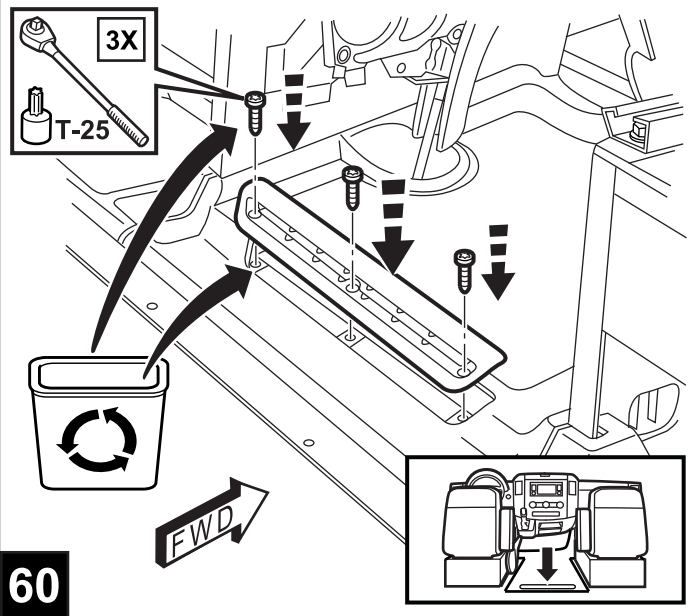
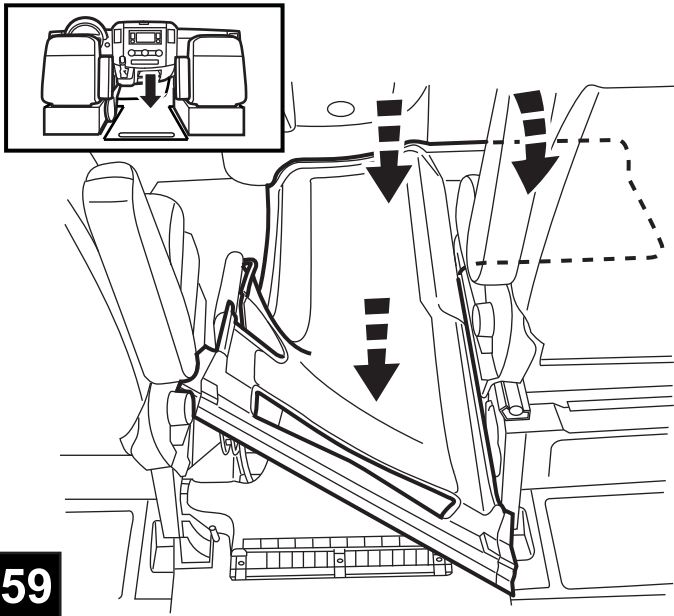

STANDARD VAN

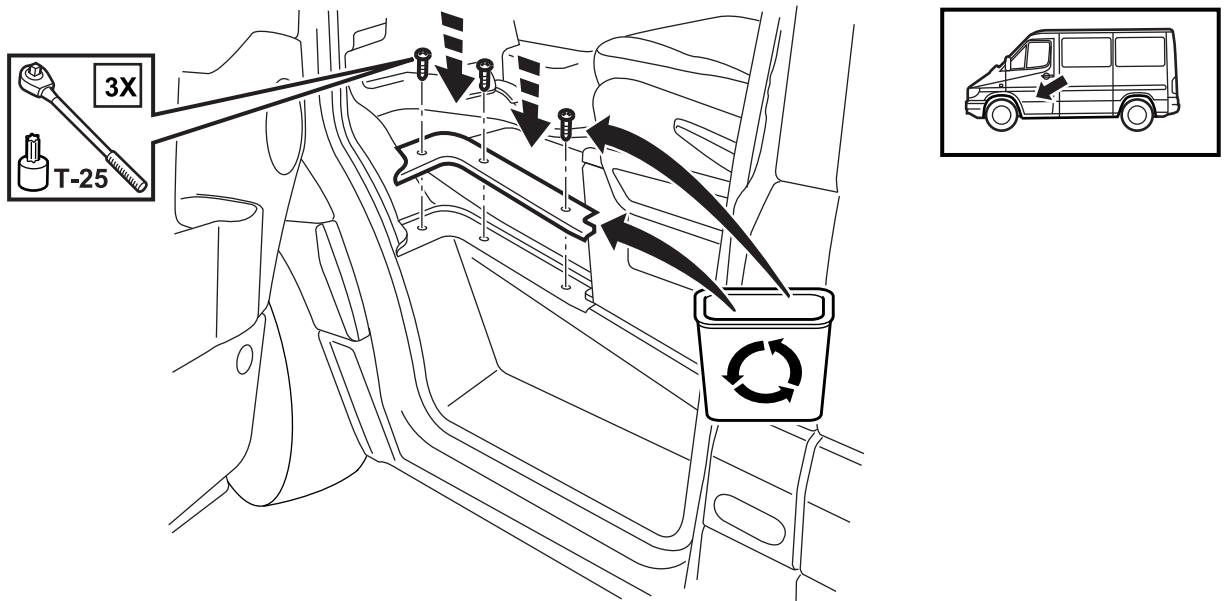

65

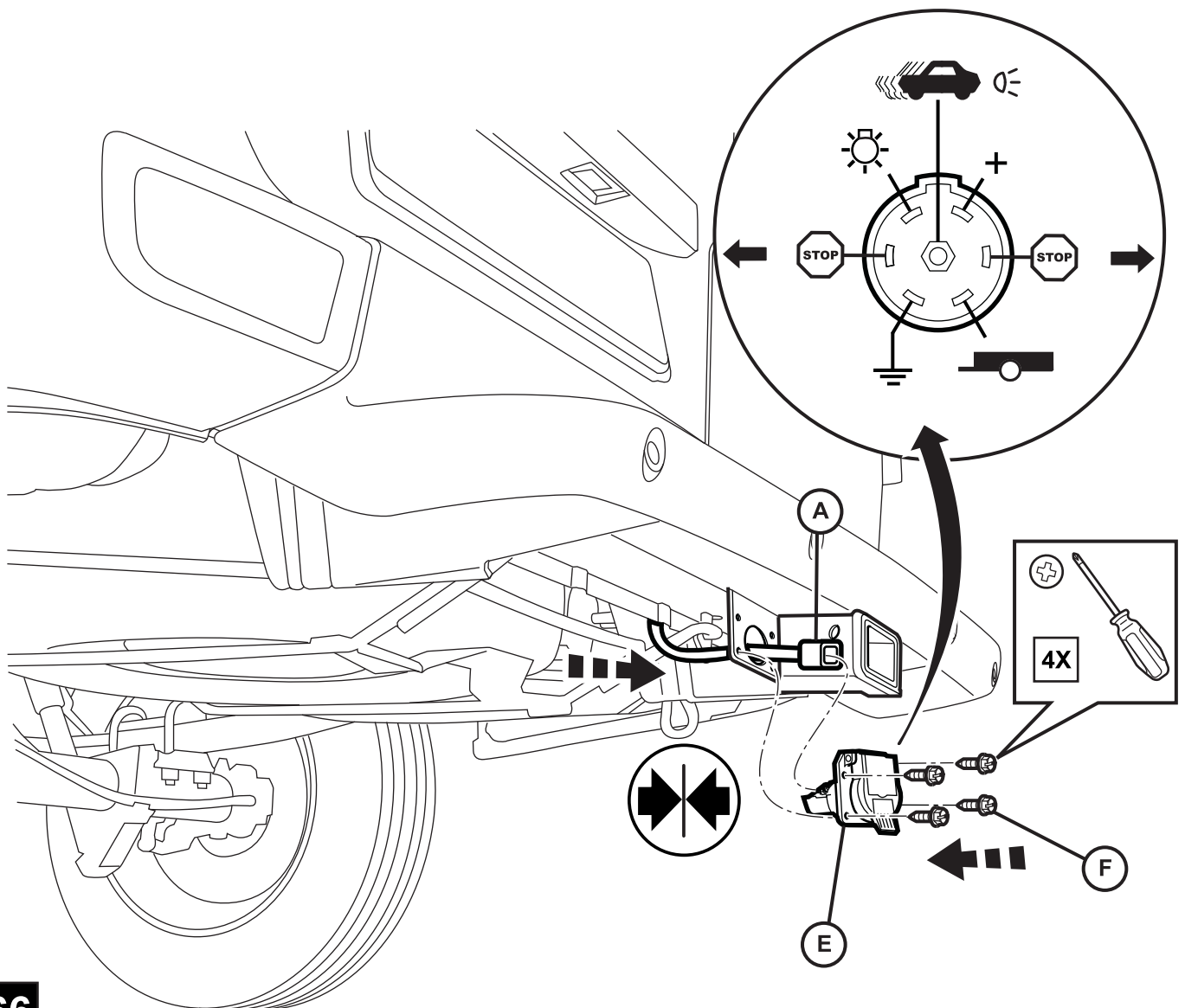

66

170 EXTENDED VAN

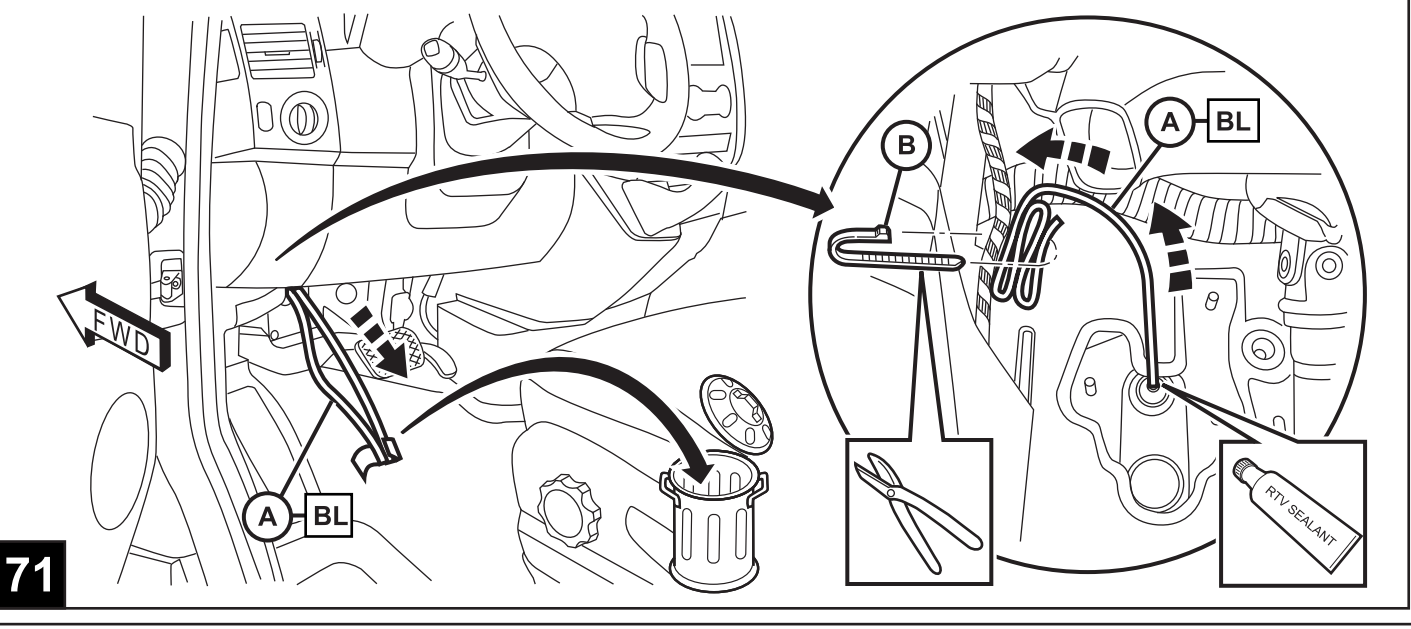
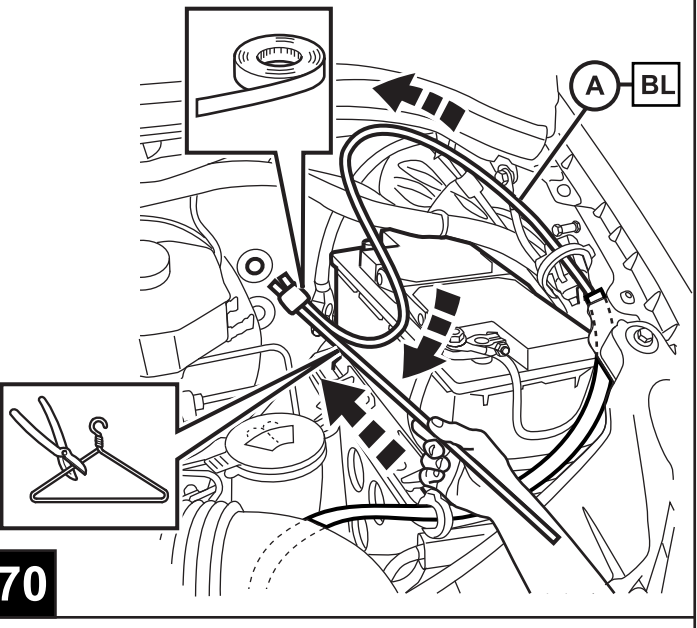
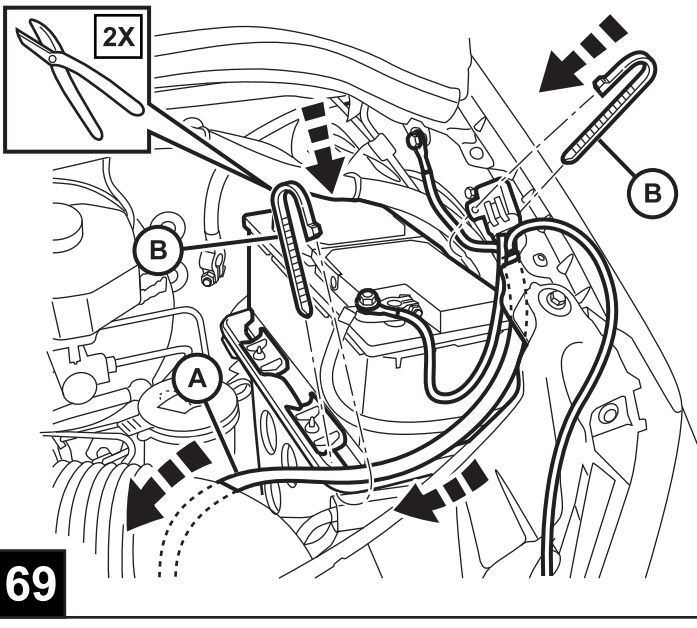
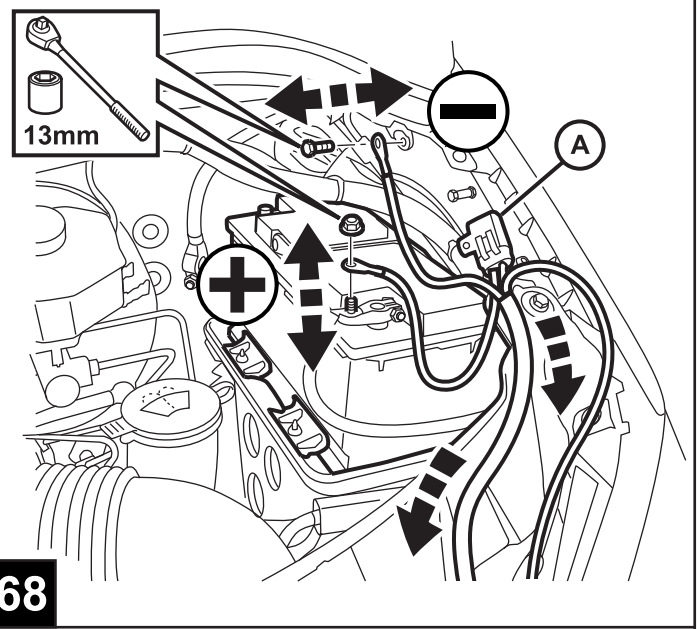
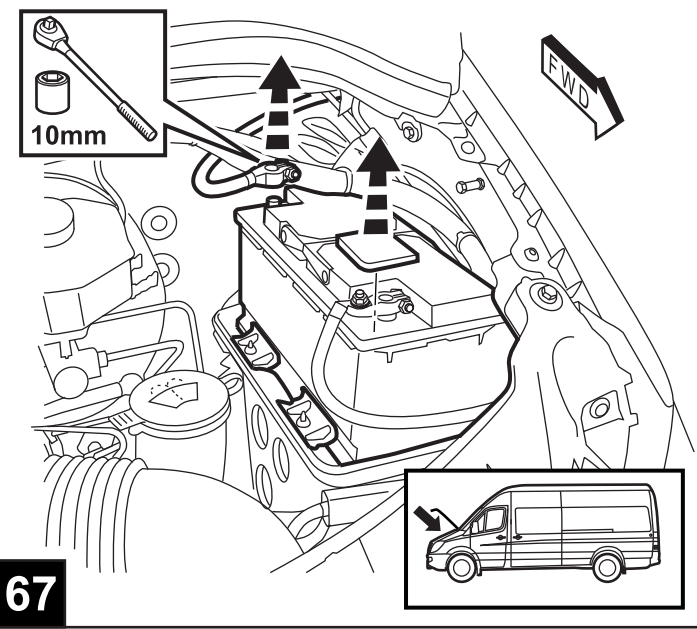

⚠ CAUTION ⚠

WHEN ROUTING TOW HARNESS THROUGH ENGINE COMPARTMENT, HARNESS MUST BE MOUNTED AWAY FROM EXHAUST MANIFOLD HEAT SHIELD AND EXHAUST PIPE.

⚠ PRECAUCIÓN ⚠

Cuando encauce el arnés para remolque por el compartimiento del motor, el arnés deberá estar montado a distancia del múltiple de escape, del protector contra calor y del tubo de escape.

⚠ MISE EN GARDE ⚠

Lors de l'acheminement du faisceau de remorquage par le compartiment-moteur, le faisceau doit être positionné à l'écart du protecteur thermique du collecteur d'échappement et du tuyau d'échappement.

72

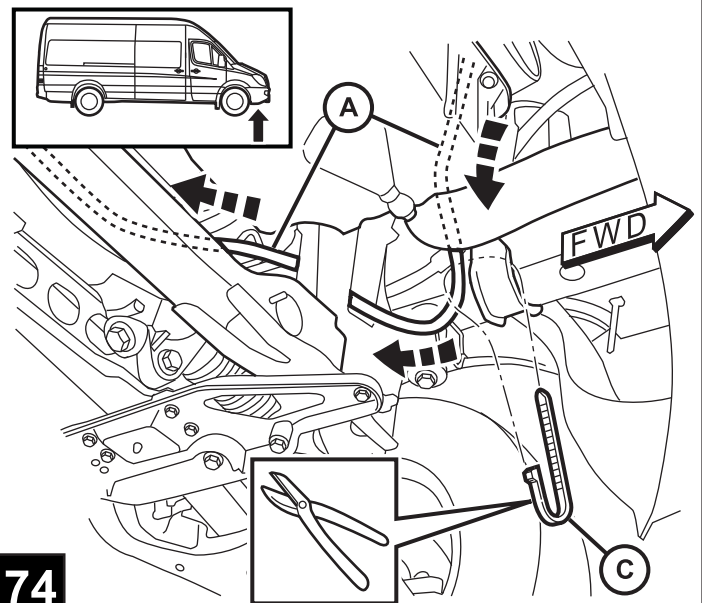
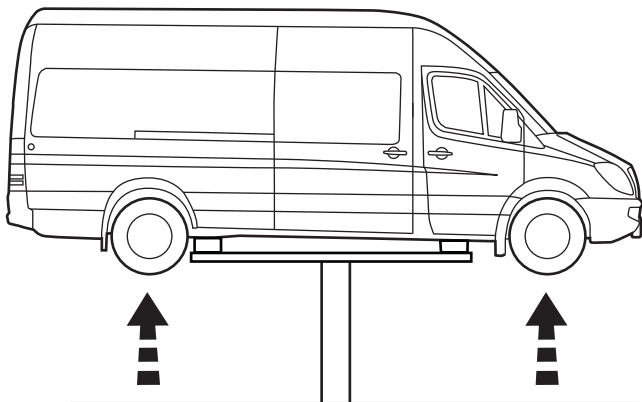

73

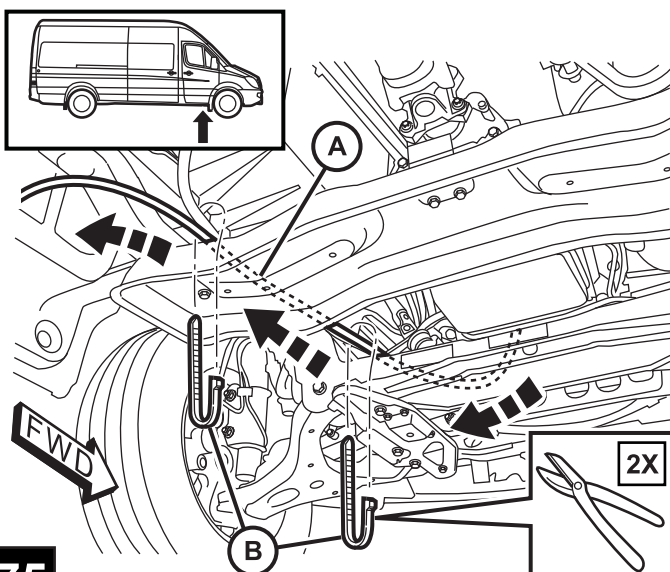

74

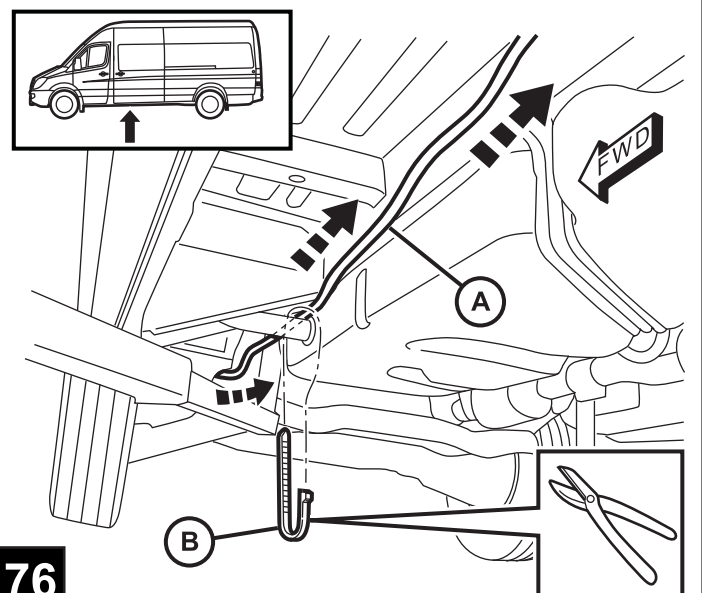

75

76

170 EXTENDED VAN

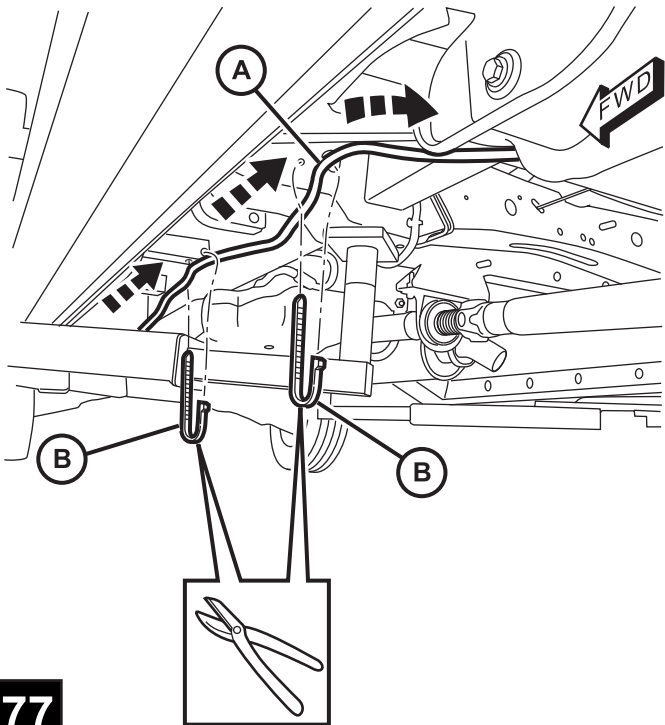
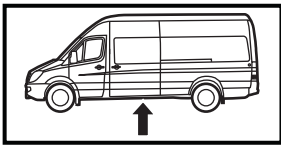

77

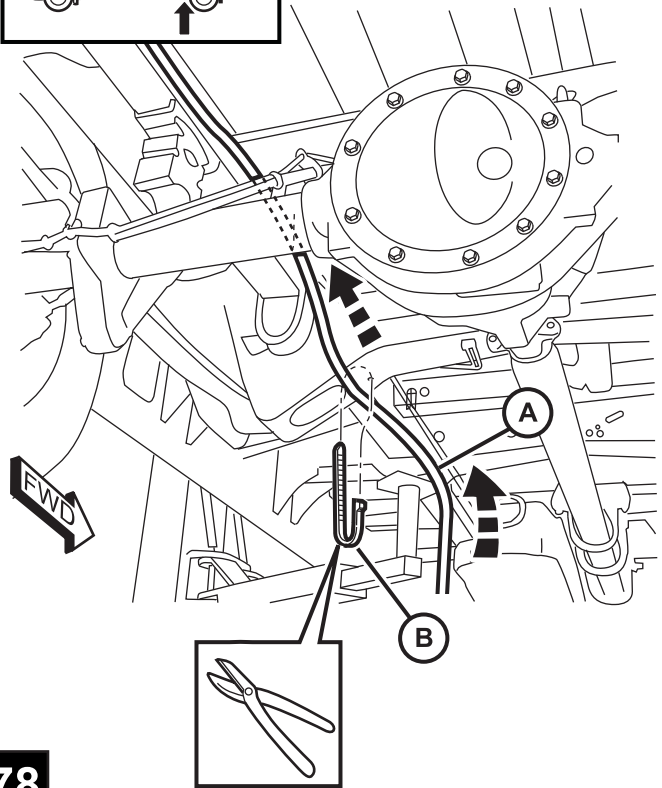
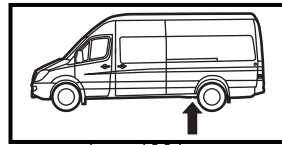

78

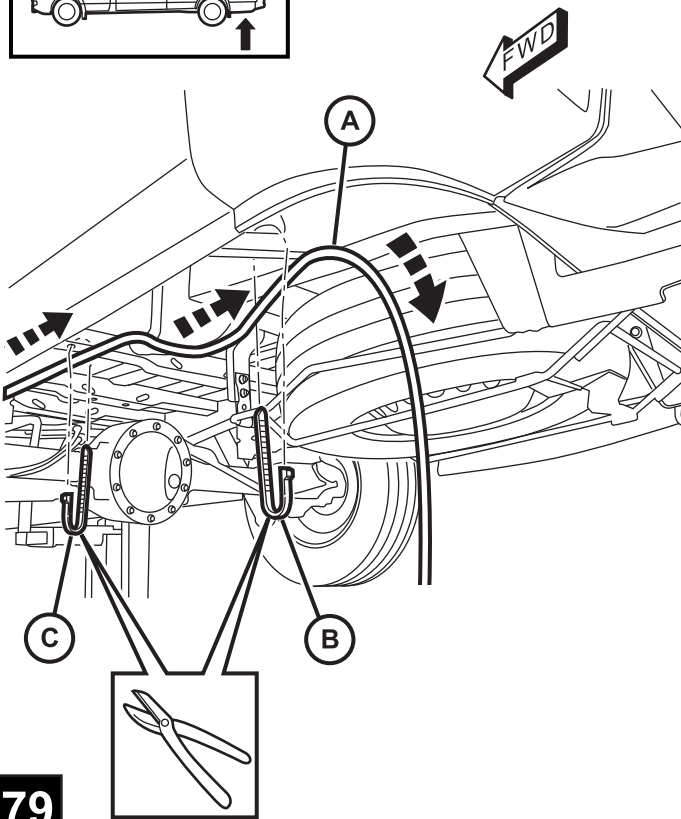
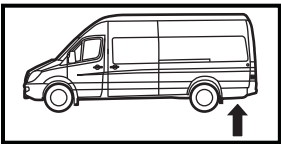

79

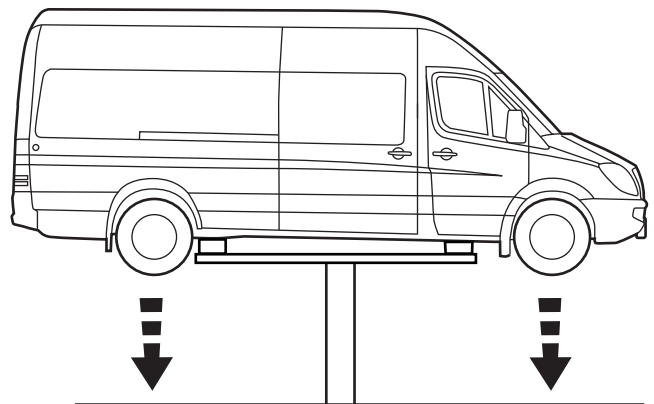

80

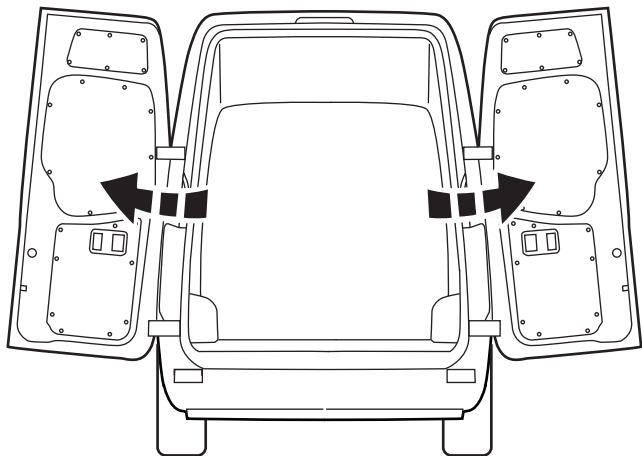

81

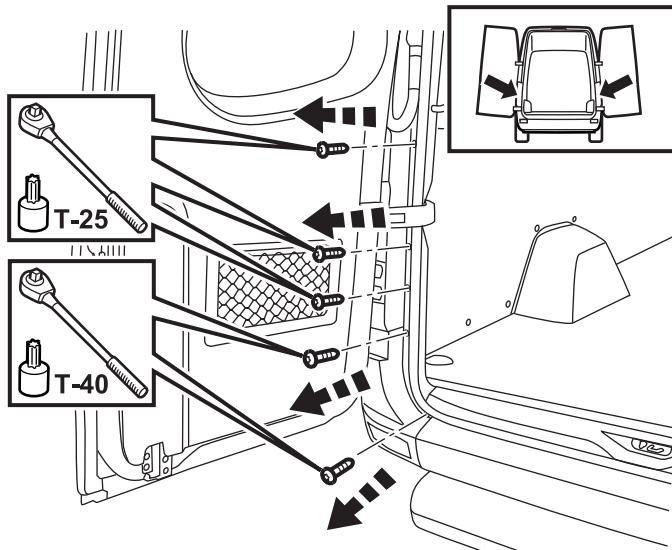

82 2X

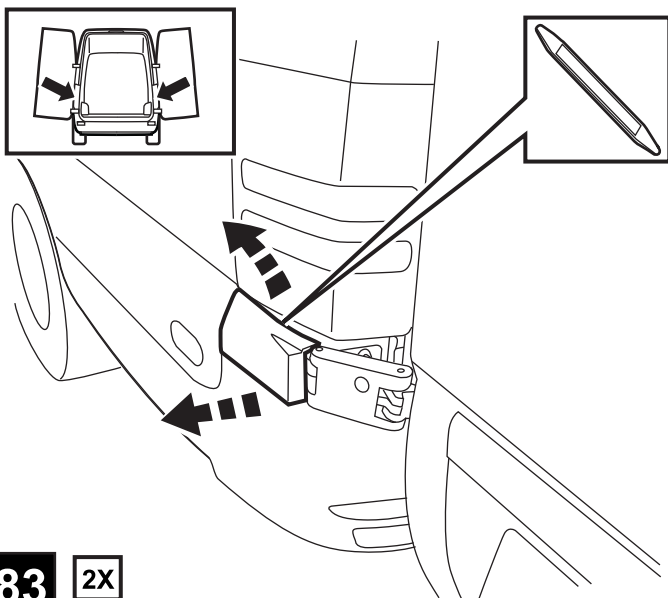

83 2X

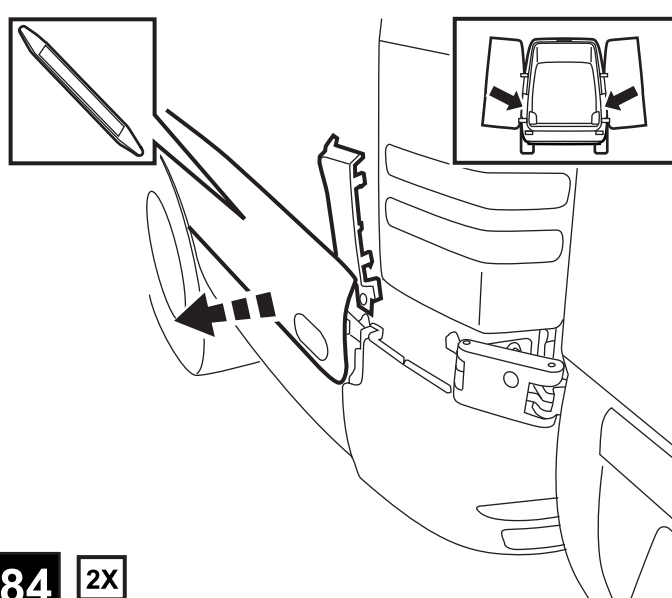

84 2X

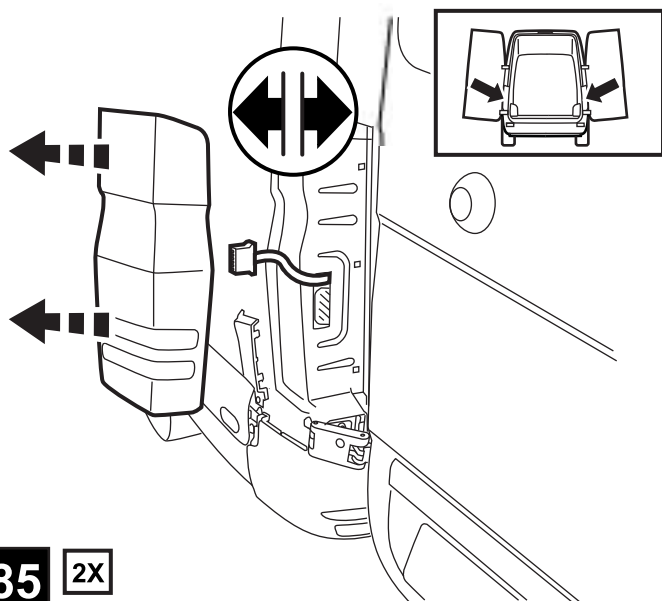

85 2X

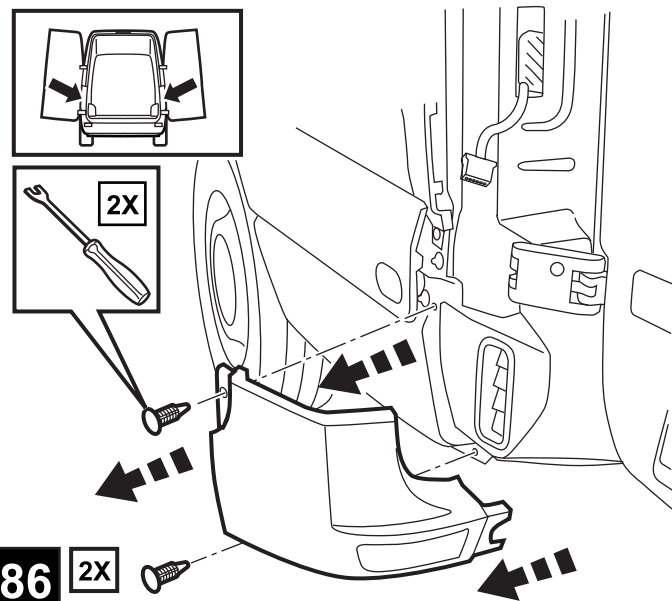

86 2X

170 EXTENDED VAN

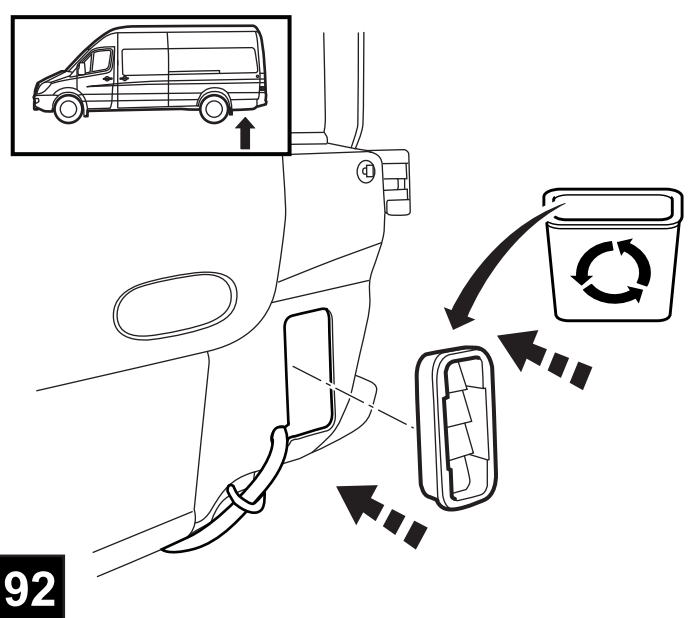
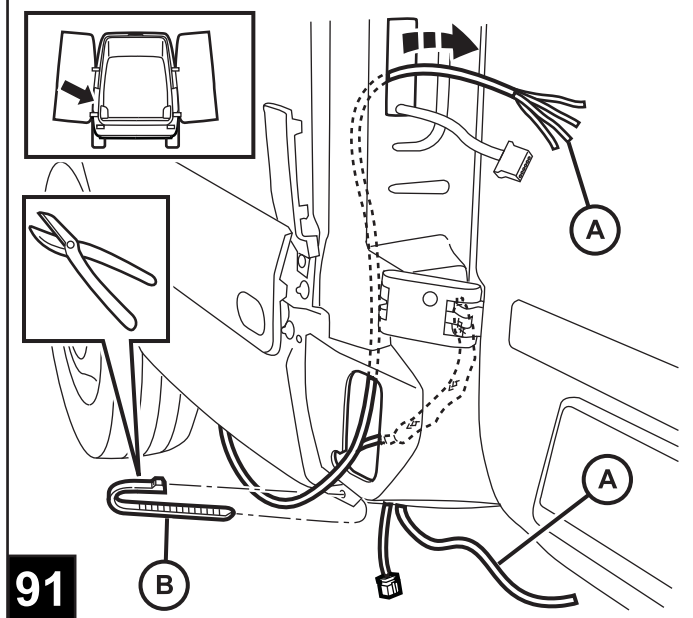
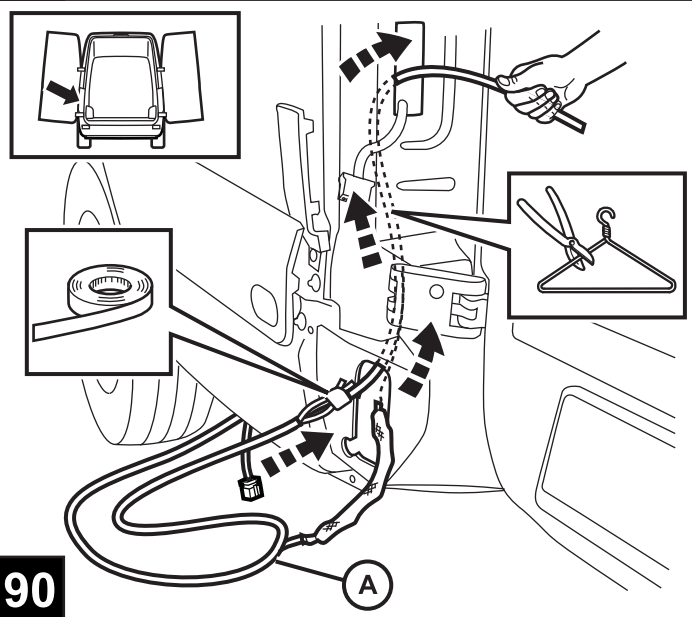
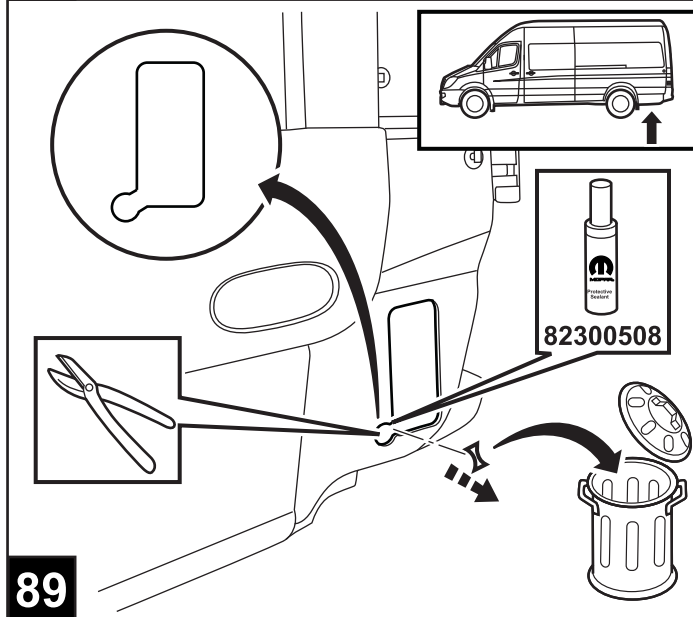
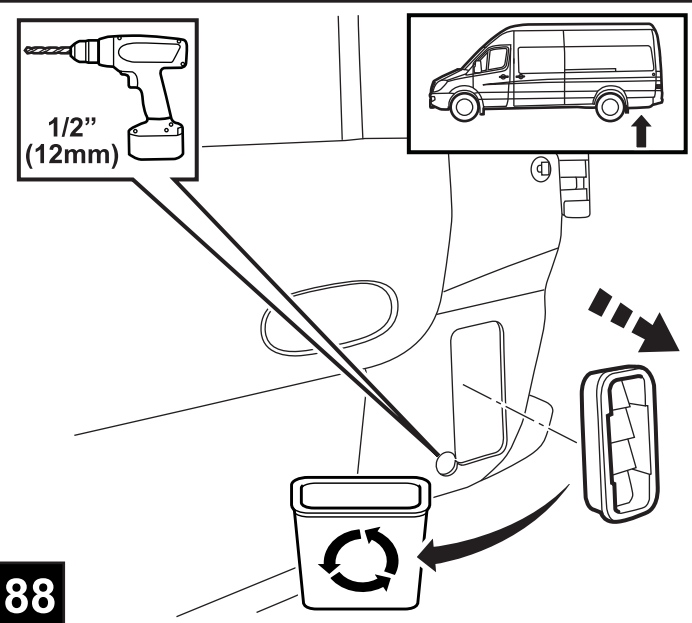
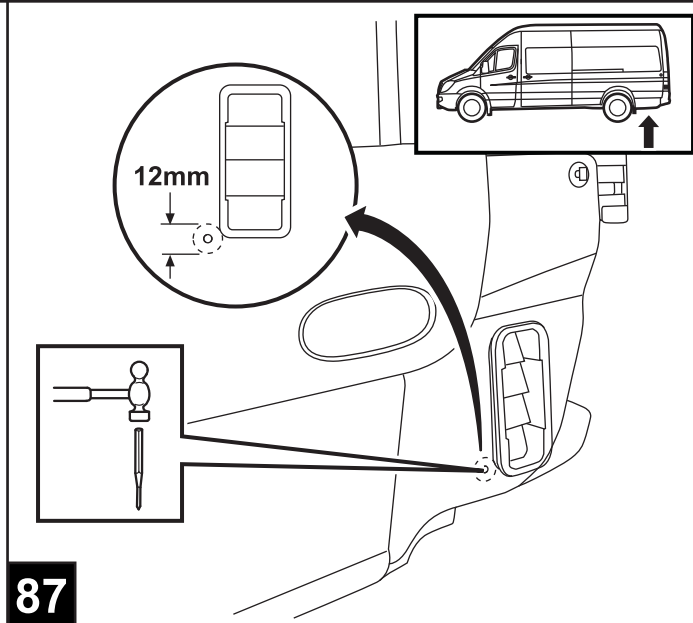

93

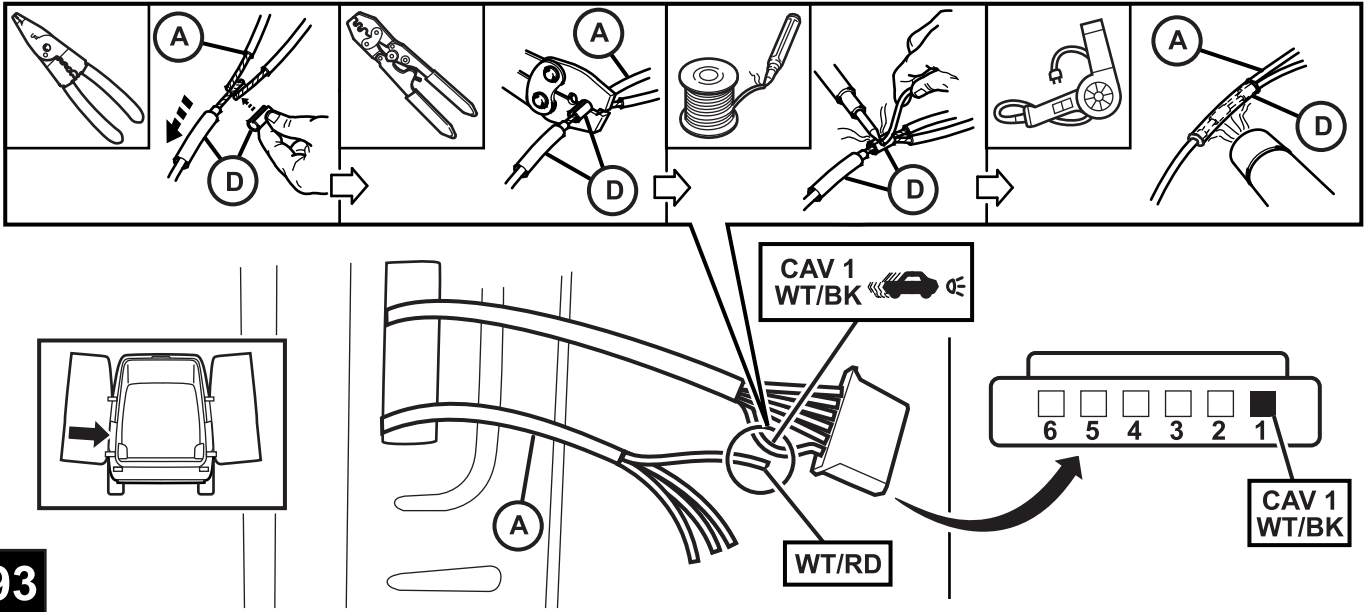

94

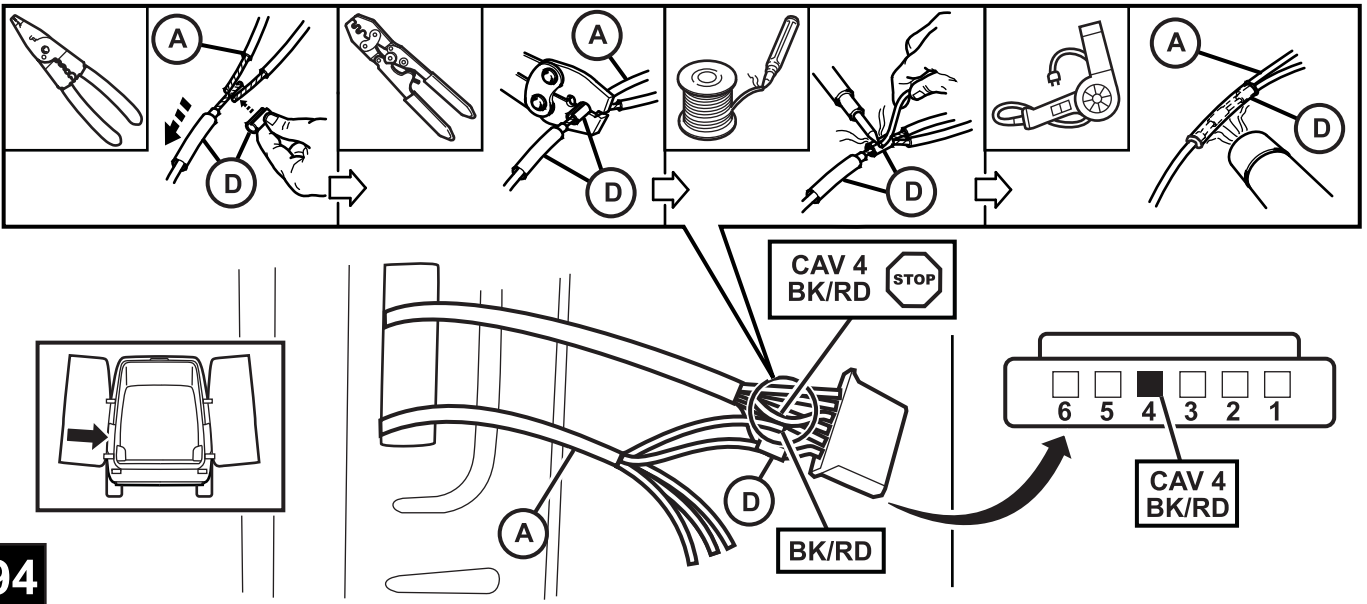

95

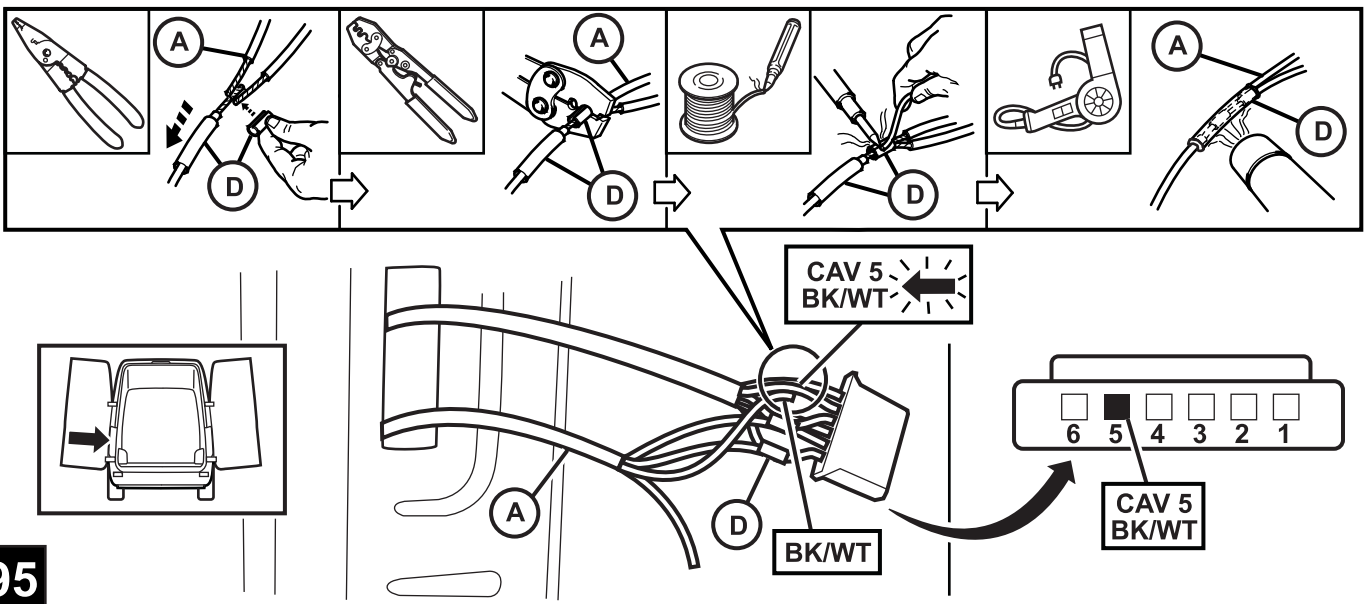

170 EXTENDED VAN

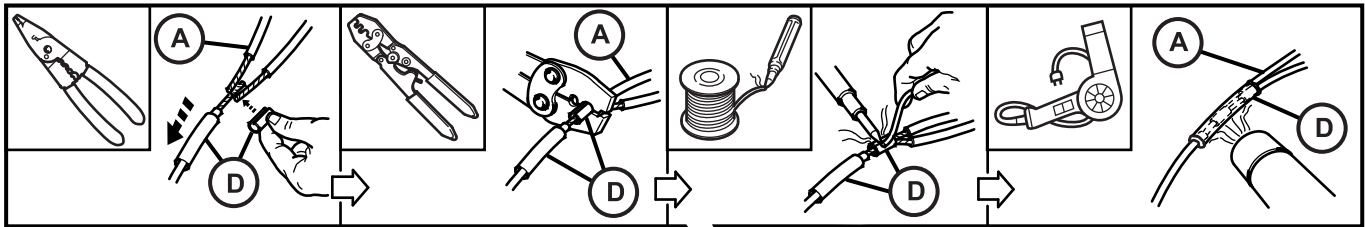

96

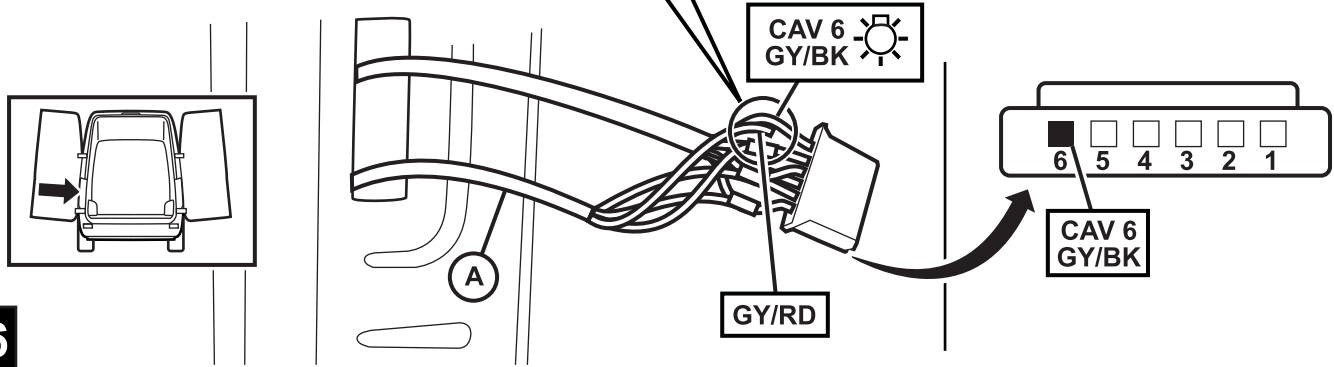

97

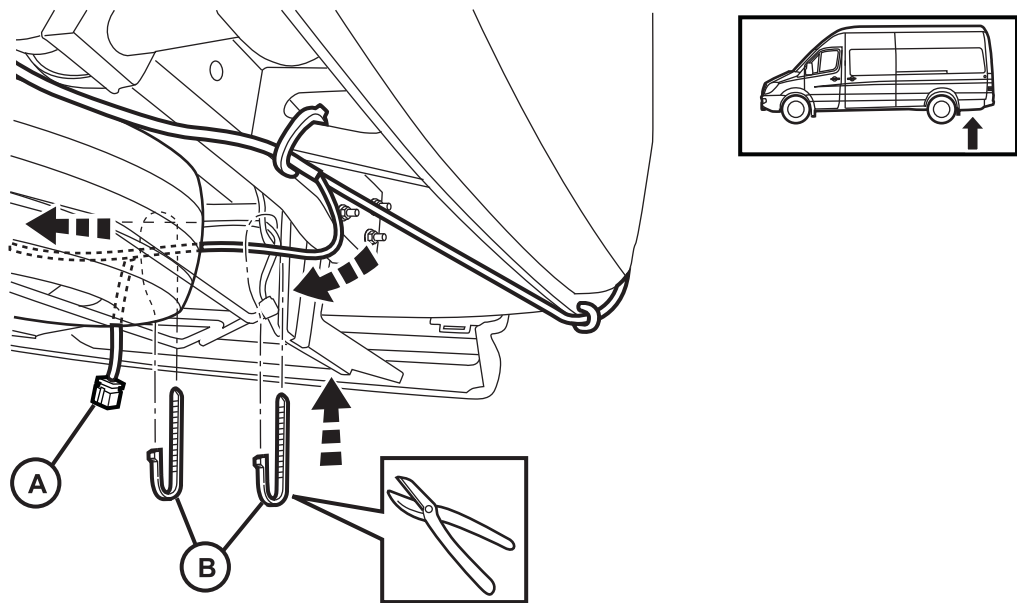

98

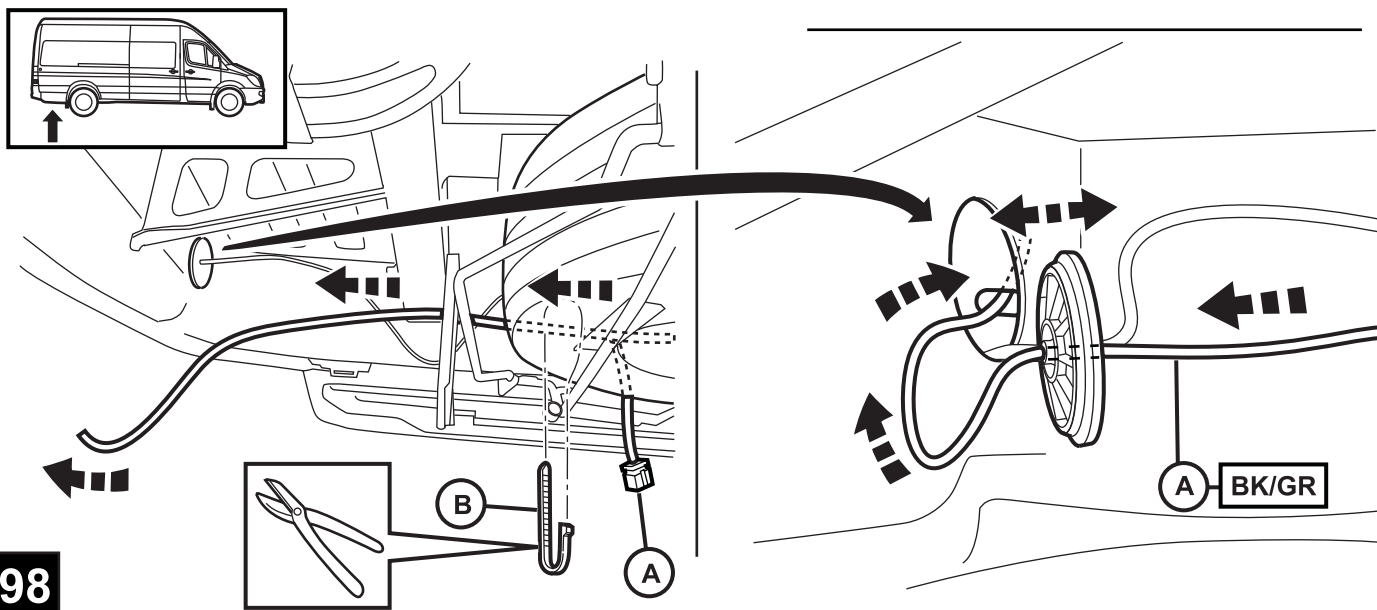

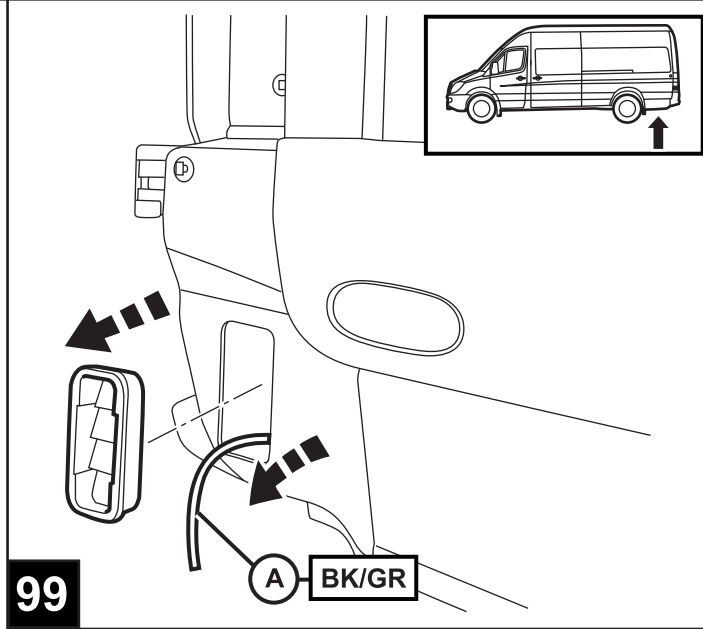

99

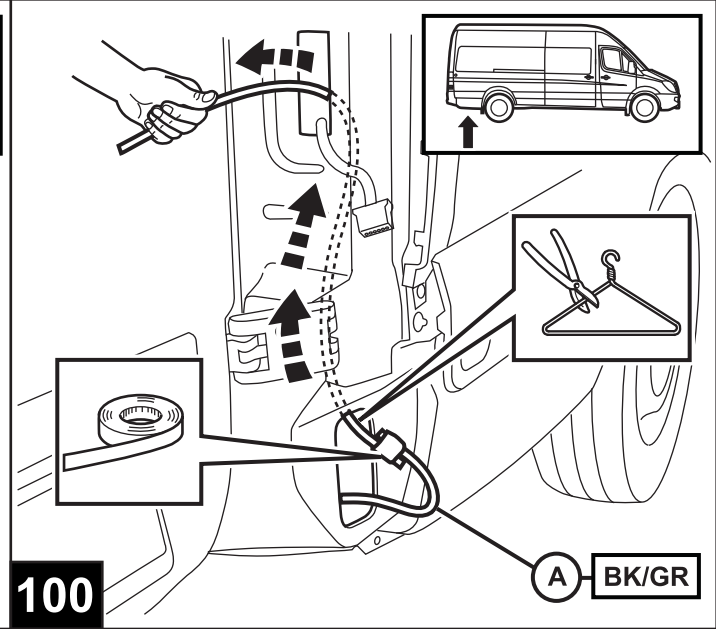

100

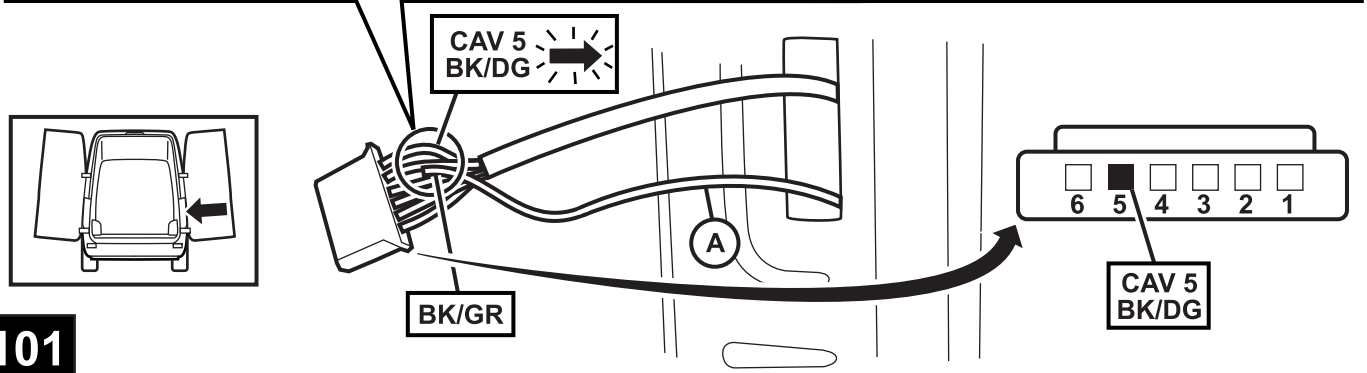
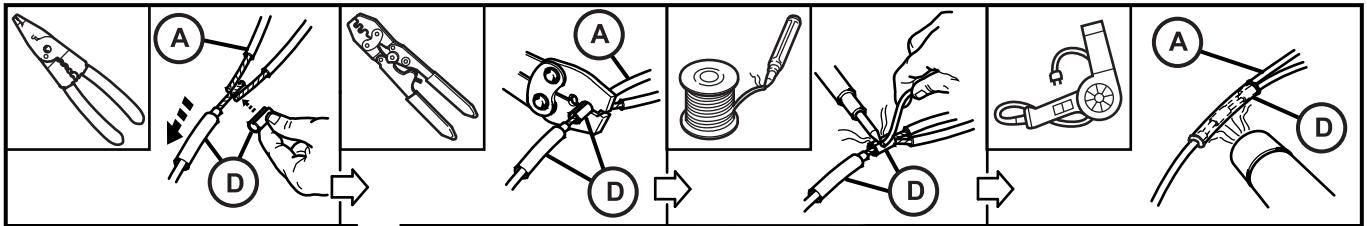

101

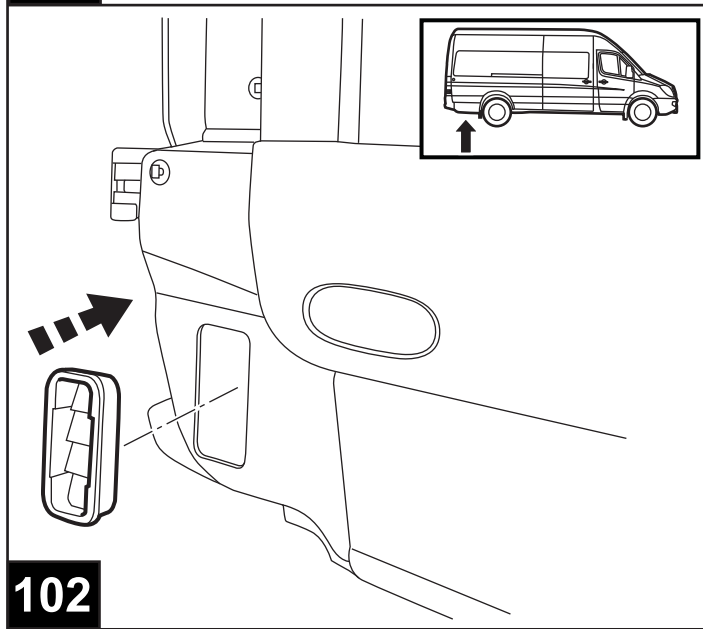

102

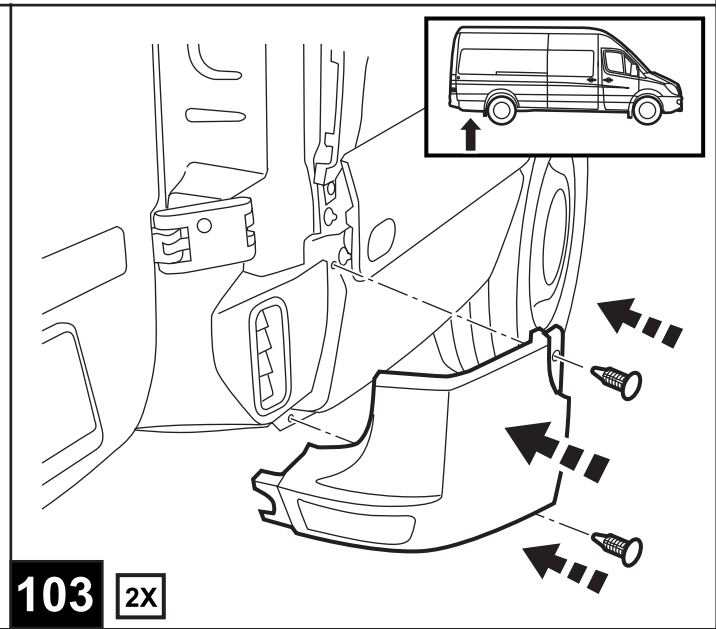

103 2X

170 EXTENDED VAN

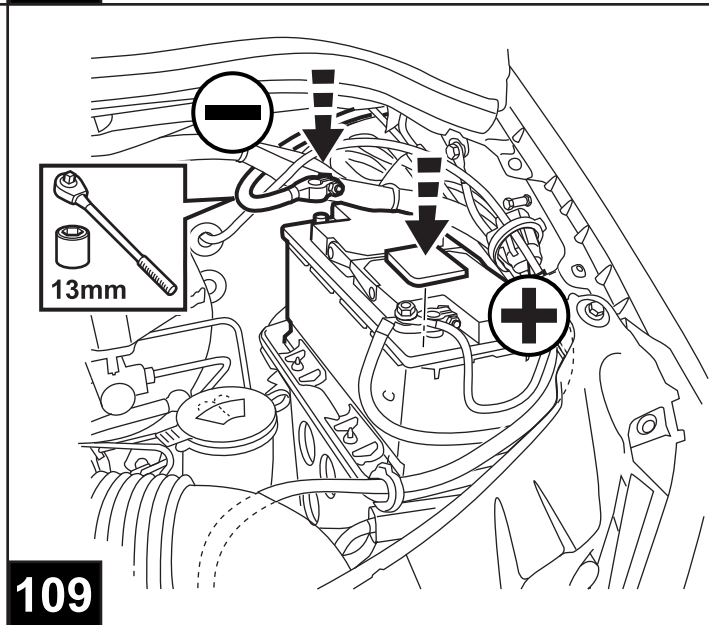
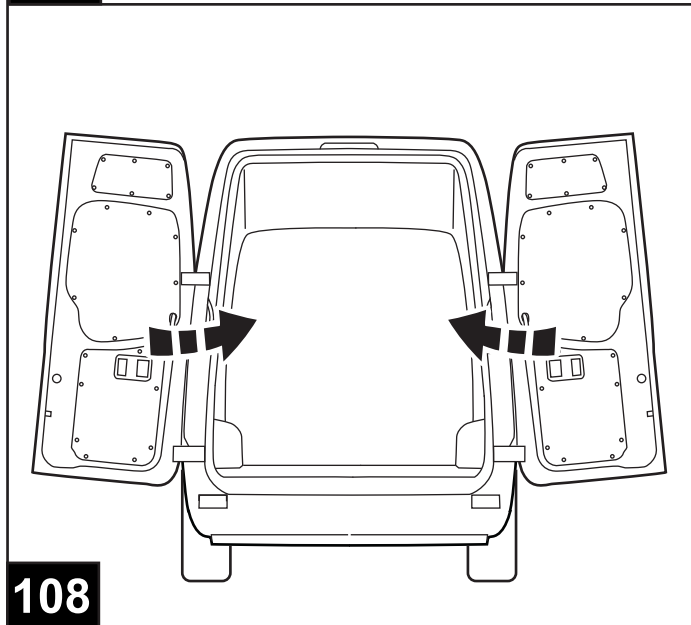
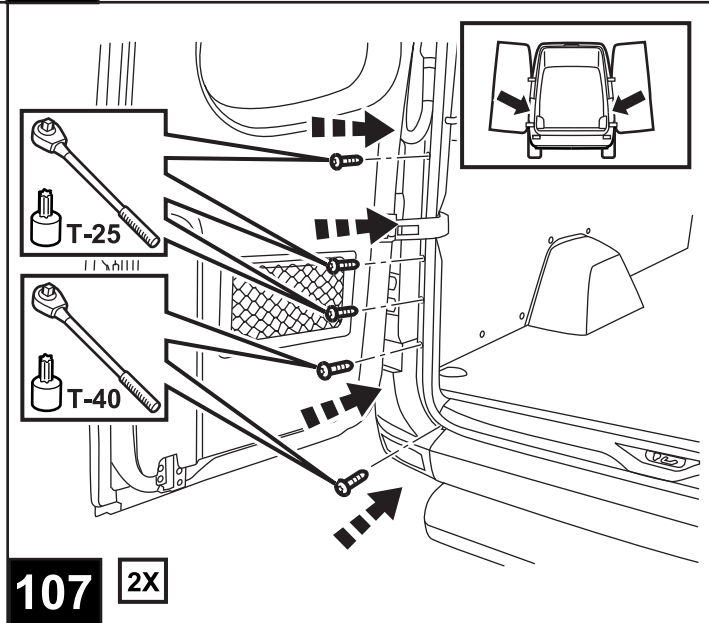
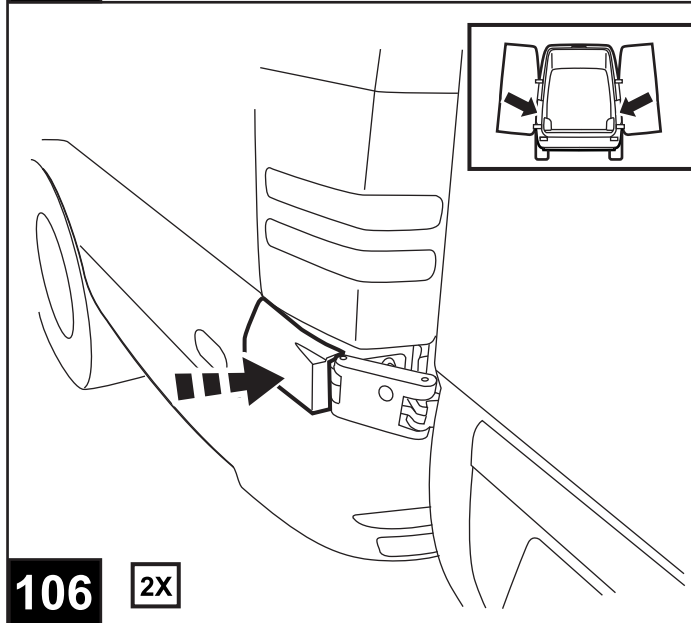
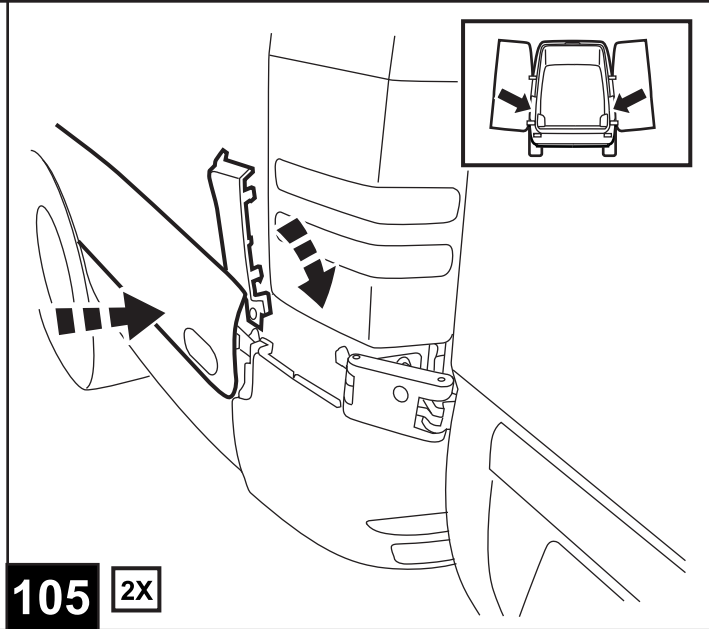
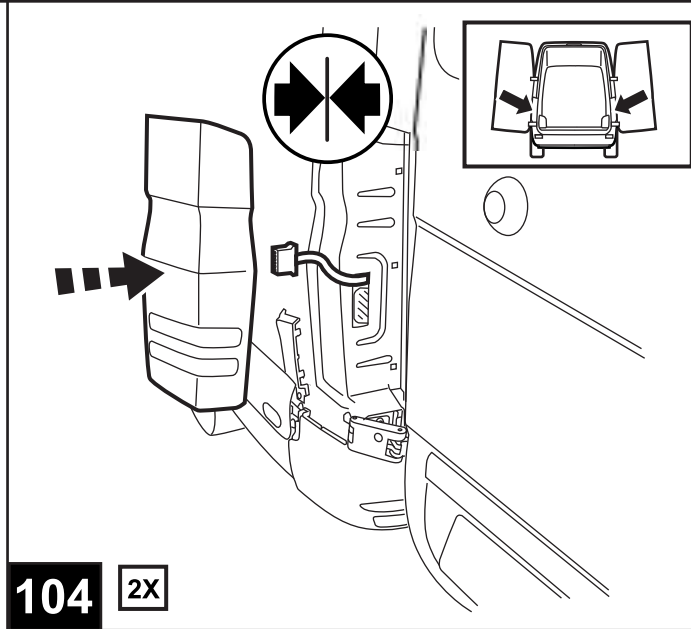

170 EXTENDED VAN

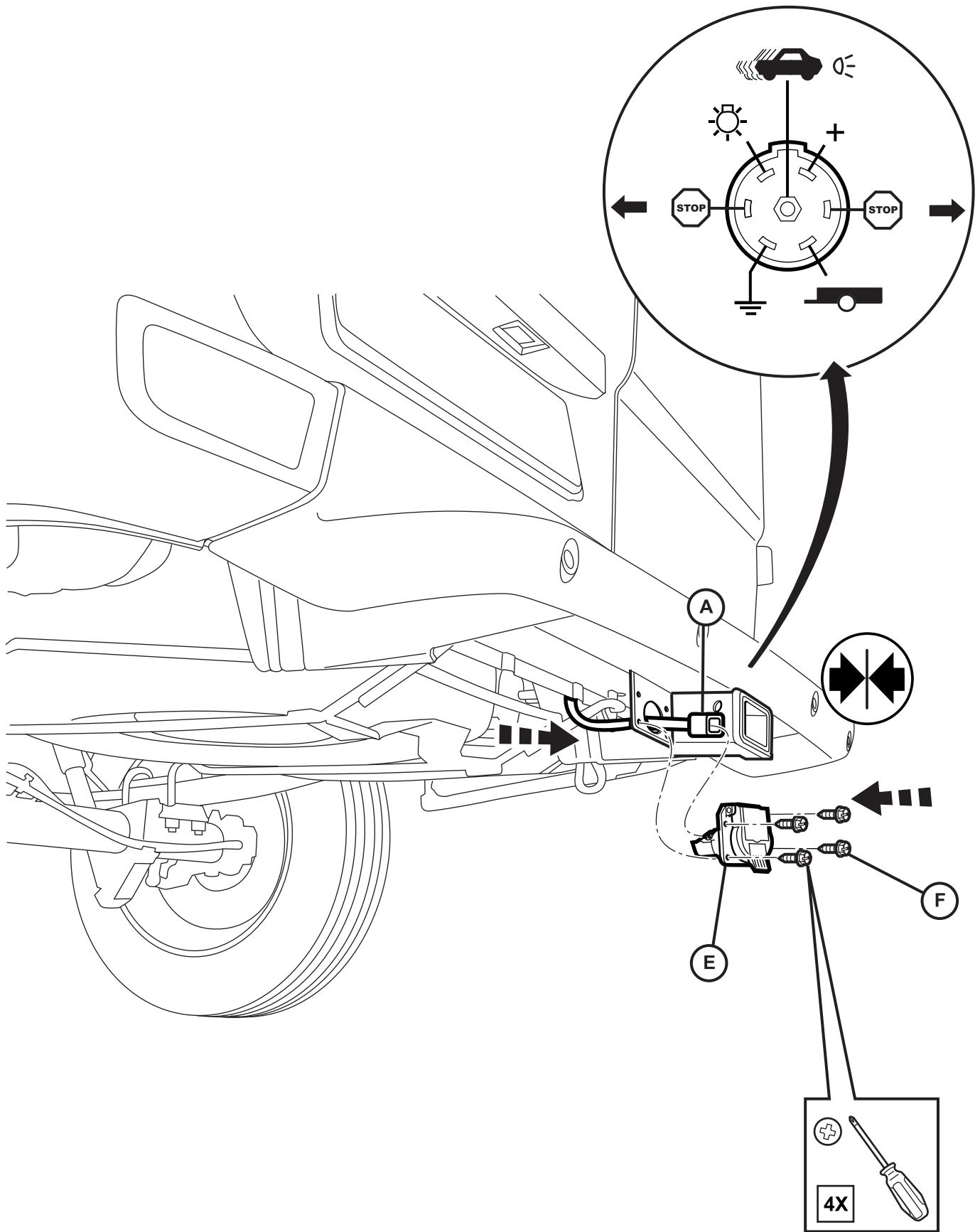

110